

STYLEVIEW[®]

Windows and Doors for New Construction



STYLEVIEW®

Windows and Doors for New Construction



YKK AP StyleView® brand vinyl windows and sliding doors for new construction are designed for years of trouble-free use. By incorporating high performance glazing and corrosion-resistant hardware with an architecturally correct design, YKK AP offers windows and doors that deliver more value and homeowner comfort.

The YKK AP philosophy of continual investment in research and development, in testing, and in production facilities has kept us in the forefront of the industries we serve. YKK AP is a worldwide leader in architectural products, committed to producing the highest quality residential product available.

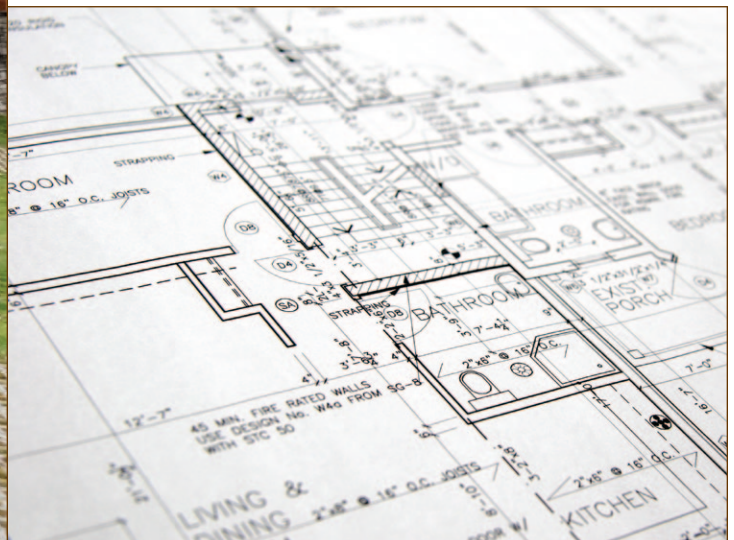



CONTENTS

Single-Hung Windows	3 – 4
Double-Hung Windows	5 – 6
Picture & Transom Windows	7 – 8
Casement & Awning Windows	9 – 12
Slider Windows	13 – 14
Geometric Windows	15 – 16
Sliding Doors	17
Options & Accessories	18



SINGLE-HUNG WINDOWS

Removable Upper Sash.

StyleView® single-hung windows are engineered to meet the demand for quality and craftsmanship while providing easy installation and enduring value. The removable upper sash gives StyleView single-hung windows a look comparable to traditional double-hungs. The windows provide a simple, safe opening for drywall pass-through and repair. Twin and triple continuous head and sill units can be provided, eliminating the need for mulling separate units together.

- A Integral 180 Brick Mould and J-Channel:**
Produces a rich detailed appearance while reducing labor and material costs associated with J-channel applications
- B Removable Upper Sash:**
Renders a real double-hung look while providing for simple economical repair and drywall pass-through
- C Interlocking Sash:**
Improves structural performance and adds security
- D Tilt-In Bottom Sash:**
Makes cleaning easier
- E Fusion-Welded Sloped Sill & Projected Sill Nose:**
For an architecturally correct look and improved water rating

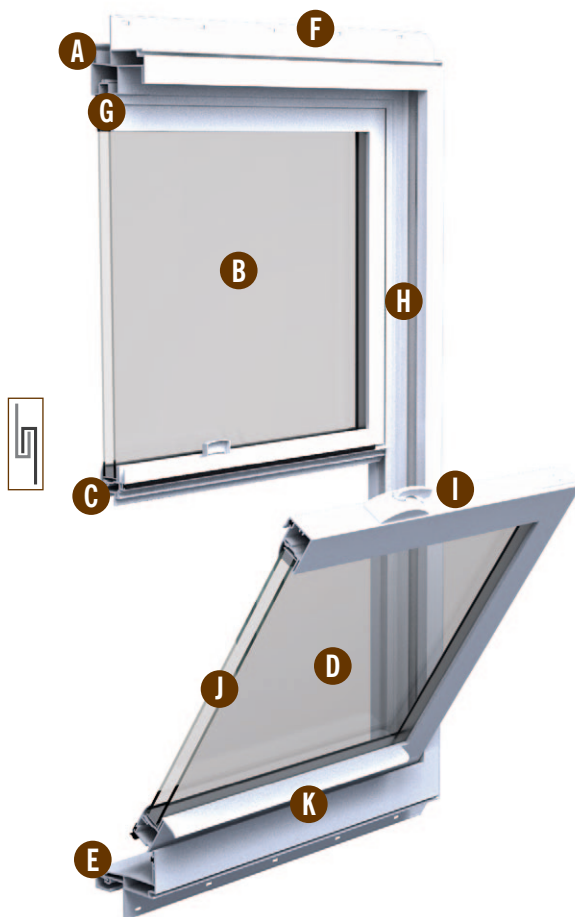

- F Integral 1" Nail Fin:**
Provides easy user-friendly installation
- G Double Weather Stripping:**
Optimum protection against air, water, noise, and dust infiltration
- H Constant-Force Teflon®-Coated Stainless Steel Balance:**
Corrosion-resistant and never needs adjustment
- I Proprietary Cam Lock:**
Provides tight weather seal and distinctive styling with concealed fasteners
- J 3/4" Insulated Glass:**
Low-E and low-conductance spacers are standard for optimal thermal efficiency
- K Integral Lift Rail:**
Enables easy sash operation

①	20"	24"	28"	30"	32"	36"	38"	40"	44"	48"
	② 19-1/2"	23-1/2"	27-1/2"	29-1/2"	31-1/2"	35-1/2"	37-1/2"	39-1/2"	43-1/2"	47-1/2"
36"										
38"										
44"										
46"										
48"										
50"										
52"										
54"										
60"										
62"										
66"										
72"										
74"										



Single-Hung Windows

- ① Rough Opening
- ② Actual Window Size (frame, excluding brick mould)
- All dimensions are inches.
- Shading indicates window meets 5.7 sq. ft. egress.
- Darker shading indicates sizes with tempered glass do not meet egress. These sizes will meet egress with annealed glass.
- For twins, double rough opening of single.
- For triples, triple rough opening of single.

Also available in 80" and 84" heights. Consult ViewBuilder for specifications.

DOUBLE-HUNG WINDOWS



YKK AP builds StyleView® double-hung windows for years of reliable, trouble-free performance. Quality construction begins with our proprietary vinyl extrusion, especially formulated for superior strength and all-weather performance. Both sashes tilt in for easy cleaning, convenient for the exterior glass of upper floors. Twin and triple continuous head and sill units can be provided, eliminating the need for mulling separate units together.

A Integral 180 Brick Mould and J-Channel:
Produces a rich detailed appearance while reducing labor and material costs typical of J-channel applications

B 3/4" Insulated Glass:
Low-E and low-conductance spacers are standard for optimal thermal efficiency

C Tilt-In Bottom and Top Sash:
Makes cleaning easier

D Interlocking Sash:
Improves structural performance and window seal

E Double Weather Stripping:
Optimum protection against air, water, noise, and dust infiltration

F Fusion-Welded Sloped Sill and Projected Sill Nose:
For an architecturally correct look and improved water rating

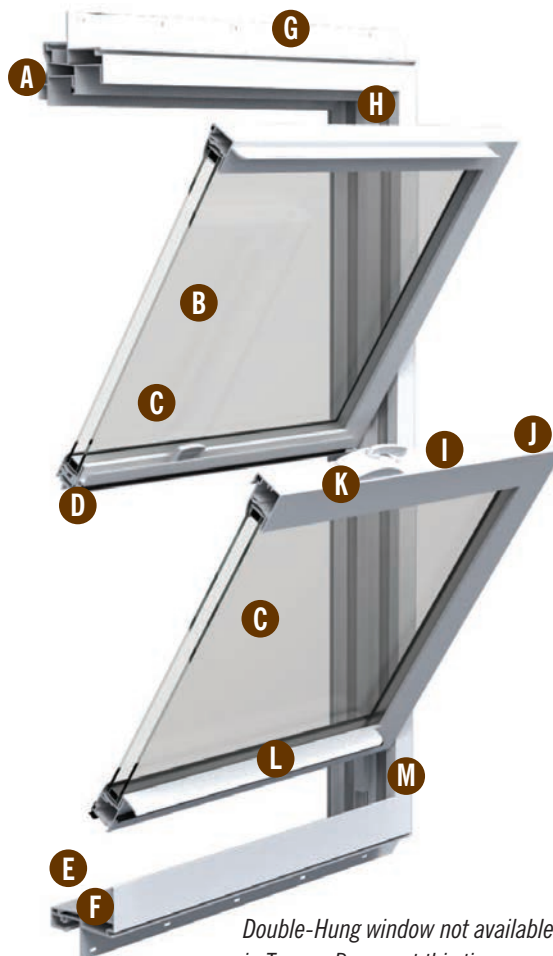

Double-Hung window not available in Tuscan Bronze at this time

G Integral 1" Nail Fin:
Provides easy installation

H Constant-Force Teflon®-Coated Stainless Steel Balance:
Corrosion-resistant and never needs adjustment

I Proprietary Cam Lock:
Provides tight weather seal and distinctive styling with concealed fasteners

J Flush-Mounted Tilt Latches:
Aesthetically designed to meet structural loads

K Corrosion-Resistant Hardware:
For lasting durability in the harshest environments

L Integral Lift Rail:
Enables easy sash operation

M Fusion-Welded Frame and Sash:
Enhances structural integrity and improves energy efficiency



①	20"	24"	28"	30"	32"	36"	38"	40"	44"	48"
	19-1/2"	23-1/2"	27-1/2"	29-1/2"	31-1/2"	35-1/2"	37-1/2"	39-1/2"	43-1/2"	47-1/2"
36"	35-1/2"									
38"	37-1/2"									
44"	43-1/2"									
46"	45-1/2"									
48"	47-1/2"									
50"	49-1/2"									
52"	51-1/2"									
54"	53-1/2"									
60"	59-1/2"									
62"	61-1/2"									
66"	65-1/2"									
72"	71-1/2"									

Double-Hung Windows

- ① Rough Opening
- ② Actual Window Size (frame, excluding brick mould)
- All dimensions are inches.
- Shading indicates window meets 5.7 sq. ft. egress.
- Darker shading indicates sizes with tempered glass do not meet egress. These sizes will meet egress with annealed glass.
- For twins, double rough opening of single.
- For triples, triple rough opening of single.

Also available in 74" height. Consult ViewBuilder for specifications.

TRANSOM & PICTURE WINDOWS



The high thermal efficiency of StyleView® window and door products enables enjoyment of large, stylish combinations of picture and transom windows. As a result, homeowners can open a room to more natural lighting and scenery without squandering energy.

①	Rough Opening									
	20"	24"	28"	30"	32"	36"	38"	40"	44"	
②	12"	19-1/2"	23-1/2"	27-1/2"	29-1/2"	31-1/2"	35-1/2"	37-1/2"	39-1/2"	43-1/2"
	18"	17-1/2"								
	24"	23-1/2"								
	28"	27-1/2"								

Transom Windows

① Rough Opening ② Actual Window Size

- All dimensions are inches.
- For twins, double rough opening of single.
- For triples, triple rough opening of single.
- Units are available with factory mulling.





①	12"	18"	20"	24"	30"	32"	36"	38"	40"	44"	48"	54"	60"	72"	80"
	② 11-1/2"	17-1/2"	19-1/2"	23-1/2"	29-1/2"	31-1/2"	35-1/2"	37-1/2"	39-1/2"	43-1/2"	47-1/2"	53-1/2"	59-1/2"	71-1/2"	79-1/2"
36"															
38"															
44"															
46"															
48"															
50"															
52"															
54"															
60"															
62"															
66"															
72"															
74"															

Picture Windows

- ① Rough Opening
- ② Actual Window Size (frame, excluding brick mould)
 - For twins, double rough opening of single.
 - For triples, triple rough opening of single.
 - All dimensions are inches.

Also available in widths up to 96" and 80", 84" and 96" heights. Maximum sizes (in inches): 96x72, 72x96, and 80x80. Consult ViewBuilder for specifications.

CASEMENT & AWNING WINDOWS



StyleView® casement and awning windows are easily combined in multiple units to create dramatic window effects and improved ventilation in contemporary or traditional homes.

- A** **Integral 1 1/4" Nail Fin:**
Provides easy installation
- B** **Multi-Chamber Weather Stripping:**
Optimum protection against air, water, noise, and dust infiltration
- C** **3/4" Insulated Glass:**
Low-E and low-conductance spacers are standard for optimal thermal efficiency
- D** **Hinges:**
Pivot to 90 degrees enabling cleaning exterior glass from inside the home
- E** **Screen Track:**
Enables easy removal from inside the home

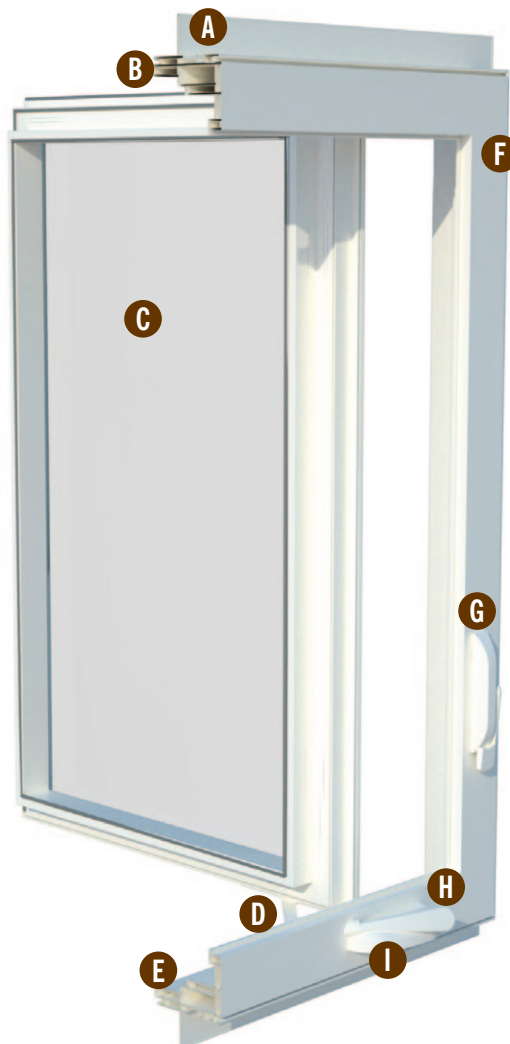

- F** **Fusion-Welded Frame and Sash:**
Enhances structural integrity and improves energy efficiency
- G** **Multi-Point Lock:**
Single handle engages multiple lock points to provide air- and water-tight seal by compressing sash securely to the frame
- H** **Powder-Coated Hardware (or Optional Stainless Steel):**
Provides protection from corrosion
- I** **Folding Operator Handle:**
Provides a clean look and avoids interference with window decorating treatments

CASEMENT WINDOWS



①	18"	20"	24"	28"	30"	36"	40"
②	17-1/2"	19-1/2"	23-1/2"	27-1/2"	29-1/2"	35-1/2"	39-1/2"
24"	23-1/2"						
36"	35-1/2"						
42"	41-1/2"						
48"	47-1/2"						
52"	51-1/2"						
60"	59-1/2"						
66"	65-1/2"						
72"	71-1/2"						
76"	75-1/2"						
80"	79-1/2"						

Caseament Windows

① Rough Opening

② Actual Window Size

- All dimensions are inches.
- Light shading indicates window meets 5.7 sq. ft. egress with standard hinges.
- Darker shading indicates egress compliance if egress hinges are specified. A casement with standard hinges cannot be converted to egress compliance.
- For twins, double rough opening of single.
- For triples, triple rough opening of single.

Left Hinge

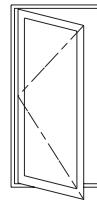

Right Hinge



Caseament Vent Layout:

When ordering, specify left or right hinge configuration as viewed from outside.



CASEMENT PICTURE WINDOWS



①	20"	24"	28"	30"	36"	48"	60"
	② 19-1/2"	23-1/2"	27-1/2"	29-1/2"	35-1/2"	47-1/2"	59-1/2"
36"							
42"							
48"							
52"							
60"							
66"							
72"							
80"							

Casement Picture Windows

① Rough Opening ② Actual Window Size

- All dimensions are inches.
- For twins, double rough opening of single.
- For triples, triple rough opening of single.



AWNING WINDOWS



①		24"	36"	40"	48"	56"	60"
②		23-1/2"	35-1/2"	39-1/2"	47-1/2"	55-1/2"	59-1/2"
18"	17-1/2"						
20"	19-1/2"						
24"	23-1/2"						
28"	27-1/2"						
36"	35-1/2"						

Awning Windows

- ① Rough Opening
- ② Actual Window Size
- All dimensions are inches.
- Width for twins, double rough opening of single.
- Width for triples, triple rough opening of single.
- Height for multiples: multiply single rough opening by number you choose to stack.



SLIDER WINDOWS



StyleView® slider windows extend the opportunity for creative window solutions. The functionality and warm look of these windows make them appropriate for contemporary or traditional homes.

- A Double Weather Stripping:** Optimum protection against air, water, noise, and dust infiltration
- B 3/4" Insulated Glass:** Low-E and low-conductance spacers for optimal thermal efficiency and to minimize risk of condensation
- C Proprietary Cam Lock:** Provides tight weather seal and distinctive styling with concealed fasteners
- D Brass Rollers:** For smooth, trouble-free operation
- E Removable Sash:** Enables easier cleaning from inside the home

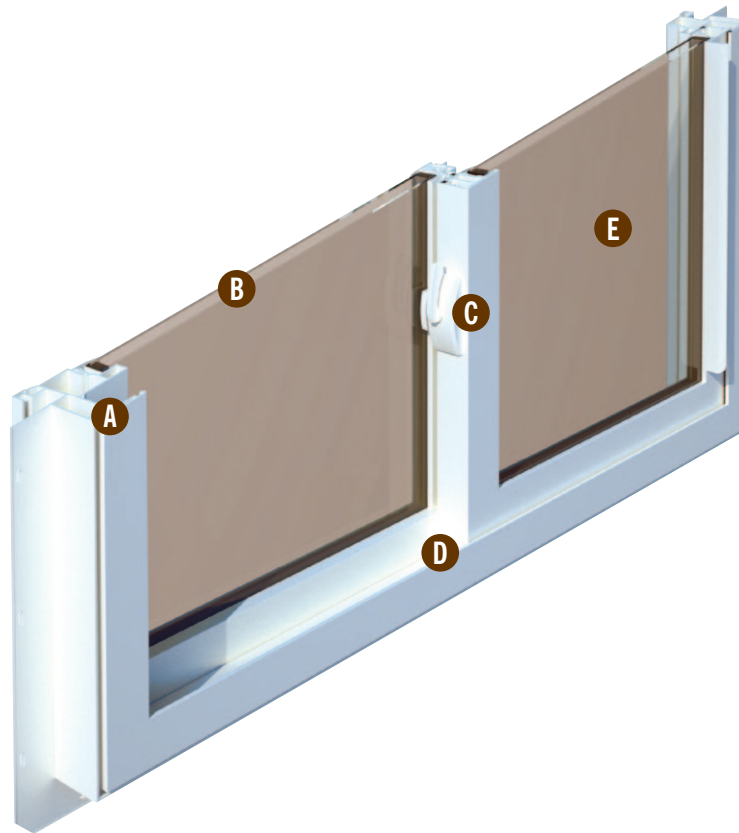



①	24"	36"	48"	50"	54"	60"	64"	72"
	② 23-1/2"	35-1/2"	47-1/2"	49-1/2"	53-1/2"	59-1/2"	63-1/2"	71-1/2"
24"								
36"								
42"								
44"								
48"								
50"								
54"								
60"								

Slider Windows

- ① Rough Opening
- ② Actual Window Size (frame, excluding brick mould)
- All dimensions are inches.
- Shading indicates window meets 5.7 sq. ft. egress.

GEOMETRIC WINDOWS



StyleView® geometric windows, available in a wide variety of standard and custom shapes, offer exciting opportunities to expand the value of windows as an architectural asset.

Circle

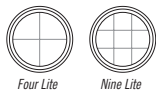

Size Code	Actual Window Size
SVCR2424	23-1/2" x 23-1/2"
SVCR3030	29-1/2" x 29-1/2"
SVCR3636	35-1/2" x 35-1/2"
SVCR4848	47-1/2" x 47-1/2"

Half Round

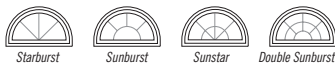

Size Code	Actual Window Size	Size Code	Actual Window Size
SVHR2412	23-1/2" x 11-1/2"	SVHR4422	43-1/2" x 21-1/2"
SVHR2814	27-1/2" x 13-1/2"	SVHR4824	47-1/2" x 23-1/2"
SVHR3015	29-1/2" x 14-1/2"	SVHR5427	53-1/2" x 26-1/2"
SVHR3216	31-1/2" x 15-1/2"	SVHR5628	55-1/2" x 11-1/2"
SVHR3618	35-1/2" x 17-1/2"	SVHR6030	59-1/2" x 29-1/2"
SVHR3819	37-1/2" x 18-1/2"	SVHR6432	63-1/2" x 31-1/2"
SVHR4020	39-1/2" x 19-1/2"	SVHR7236	71-1/2" x 35-1/2"

Oval & Half Oval



Size Code	Actual Window Size	Size Code	Actual Window Size
SVOV2436	23-1/2" x 35-1/2"	SVHO1824	17-1/2" x 23-1/2"
SVOV3656	35-1/2" x 55-1/2"	SVHO2836	27-1/2" x 35-1/2"

Elliptical

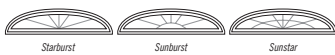

Size Code	Actual Window Size
SVPE6018	59-1/2" x 17-1/2"
SVPE7220	71-1/2" x 19-1/2"

Gothic

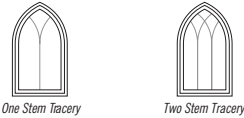

Size Code	Actual Window Size	Size Code	Actual Window Size
SVGO1836	17-1/2" x 35-1/2"	SVGO2856	27-1/2" x 55-1/2"
SVGO2040	19-1/2" x 39-1/2"	SVGO3060	29-1/2" x 59-1/2"
SVGO2244	21-1/2" x 43-1/2"	SVGO3672	35-1/2" x 71-1/2"
SVGO2448	23-1/2" x 47-1/2"		

Half Gothic

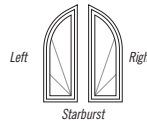

Size Code (left)	Size Code (right)	Actual Window Size
SVHGL1854	SVHGR1854	17-1/2" x 53-1/2"
SVHGL2260	SVHGR2260	21-1/2" x 59-1/2"
SVHGL2666	SVHGR2666	25-1/2" x 65-1/2"
SVHGL2872	SVHGR2872	27-1/2" x 71-1/2"

Octagon



Size Code	Actual Window Size
SVOC2424	23-1/2" x 23-1/2"
SVOC3232	31-1/2" x 31-1/2"
SVOC3636	35-1/2" x 35-1/2"
SVOC4848	47-1/2" x 47-1/2"

Quarter Round

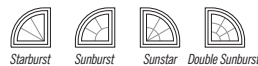

Size Code (left)	Size Code (right)	Actual Window Size
SVORL20	SVORR20	19-1/2" x 19-1/2"
SVORL24	SVORR24	23-1/2" x 23-1/2"
SVORL28	SVORR28	27-1/2" x 27-1/2"
SVORL30	SVORR30	29-1/2" x 29-1/2"
SVORL32	SVORR32	31-1/2" x 31-1/2"
SVORL36	SVORR36	35-1/2" x 35-1/2"
SVORL48	SVORR48	47-1/2" x 47-1/2"

Geometric Windows

- All dimensions in inches
- Custom shapes available

FIXED EXTENDED ARCH & EYEBROW WINDOWS



Chord Height		4-3/8"	5-1/8"	5-7/8"	6-5/8"	6-7/16"	8-1/8"	9"	11-1/4"	13-1/2"	15-1/16"	17-13/16"				
Radius		18"	21"	24"	27"	30"	32"	36"	45"	54"	60-7/16"	73"				
① Rough Opening		24"	28"	32"	36"	40"	44"	48"	60"	72"	80"	96"				
② Actual Window Size		23-1/2"	27-1/2"	31-1/2"	35-1/2"	39-1/2"	43-1/2"	47-1/2"	59-1/2"	71-1/2"	79-1/2"	95-1/2"				
Series	A	11-1/2"	7-1/8"											Eyebrow		
	B	23-1/2"	19-1/8"													
	C	35-1/2"	31-1/8"													
	D	43-1/2"	39-1/8"													
	E	47-1/2"	43-1/8"													
	F	51-1/2"	47-1/8"													
	G	59-1/2"	55-1/8"													
	H	65-1/2"	61-1/8"													
	J	71-1/2"	67-1/8"													
	K	83-1/2"	79-1/8"													
	L	95-1/2"	91-1/8"													
					<p>① Rough Opening</p> <p>② Actual Window Size</p> <p>Fixed Extended Arch & Eyebrow Windows</p> <ul style="list-style-type: none"> All dimensions are inches. * Not yet available in DP50 ratings. 											
					<p>Starburst</p> <p>Cathedral</p> <p>Colonial</p>										Extended Arch	



SLIDING DOORS

StyleView® sliding doors are a beautiful option for giving a room an appealing focal point. They invite natural light into the room and take advantage of its views. Like all StyleView window and door products, our sliding doors are meticulously crafted with the finest materials and workmanship. StyleView sliding doors are designed for powerful visual appeal and years of security, energy-saving comfort and trouble-free operation.



Not available in Tuscan Bronze or Stone colors at this time.

- A Full Perimeter Weatherstripping:** Protection against air, water, noise, and dust infiltration
- B Heavy-Duty Lock:** Provides security and tight weather seal
- C Upgraded Hardware:** Precision-fit and corrosion-resistant for long lasting performance
- D Heavy-Duty Extruded Sliding Screen Door:** Standard with all StyleView doors
- E Wide Track Adjustable Rollers:** Encased bearings for smooth operation
- F Aluminum Threshold:** Lasting durability

80"	①	60"	72"	96"	Patio Door
	②	59-1/4"	71-1/4"	95-1/4"	
80"	①	30"	36"	48"	Sidelite
	②	29-3/8"	35-3/8"	47-3/8"	
12-1/2"	①	60"	72"	96"	Transom
	②	59-1/4"	71-1/4"	95-1/4"	

Sliding Doors

① Rough Opening ② Actual Door/ Window Size

- All dimensions are inches.
- Combination width, one sidelite: add rough opening for door to rough opening for sidelite.
- Combination width, two sidelites: add rough opening for door to 2x rough opening for sidelite + 1/4".
- Combination height: add rough opening of door to rough opening of transom + 1/4".



WINDOW AND DOOR OPTIONS

COLORS



Stone* Tan White Bronze** Black**

**not available for standard sliding door at this time
 **not available for double-hung, sliding windows, or standard sliding doors at this time
 Color swatches are representative only.*

ENERGY EFFICIENCY GLASS



270 Low-E (Standard)
 Reduces heat gain 50% and
 blocks 86% of sun's UV rays



366 Low-E
 Reduces heat gain 64% and
 blocks 95% of sun's UV rays

GRID PATTERNS

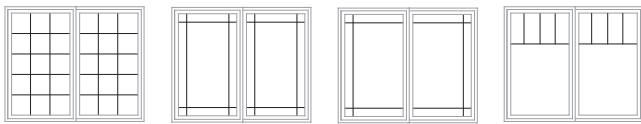

Colonial Prairie Perimeter Prairie Valance

INSTALLATION OPTIONS

The variety of installation options span a rich millwork look with a brick mould exterior to flush frames that accommodate stucco and block construction.

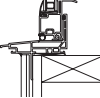
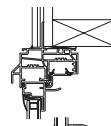

Nail Fin (Standard)

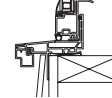
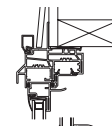

Nail Fin with Brick Mould/J-Channel Option

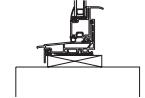
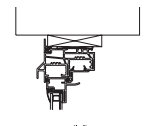

Flange for Block Construction

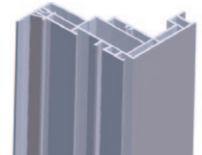
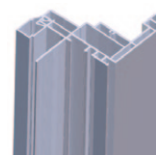
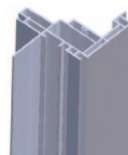

GLASS APPEARANCE

Select from three glass appearance options for enhanced style, light management, and privacy:



Clear

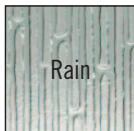

Rain



Obscure

GRID STYLES (FACE WIDTH: 7/8")

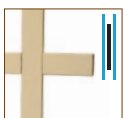

Flat Grids Between Glass

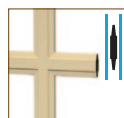

Sculptured Grids Between Glass



Simulated Divided Lights



STYLEVIEW® WINDOW AND DOOR QUALITY GUARANTEED

YKK AP stands behind every StyleView window and door product with a Limited Lifetime Warranty.

ENERGY STAR WINDOWS AND DOORS PERFORMANCE CRITERIA

Energy Star Climate Zones

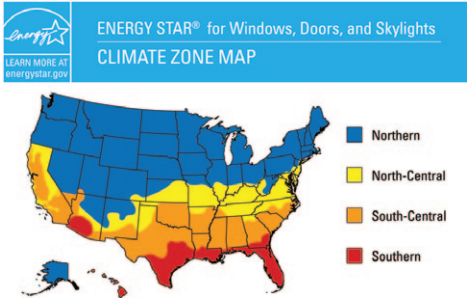

ENERGY STAR® Qualification Criteria for Residential Windows

Phase 2: Effective January, 2015

Climate Zone	U-Factor ¹	SHGC ²	
Northern	≤ 0.27	Any	Prescriptive
	– 0.28	≥ 0.32	Equivalent Energy Performance
	– 0.29	≥ 0.37	
North-Central	≤ 0.30	≤ 0.40	
South-Central	≤ 0.30	≤ 0.25	
Southern	≤ 0.40	≤ 0.25	

Glazing Level	U-Factor ¹	SHGC ²				
Opaque	≤ 0.17	No Rating				
≤ ½-Lite	≤ 0.25	≤ 0.25				
> ½-Lite	≤ 0.30	<table border="1"> <tr> <td>Northern and North-Central</td> <td>≤ 0.40</td> </tr> <tr> <td>South-Central and Southern</td> <td>≤ 0.25</td> </tr> </table>	Northern and North-Central	≤ 0.40	South-Central and Southern	≤ 0.25
Northern and North-Central	≤ 0.40					
South-Central and Southern	≤ 0.25					

¹ Btu/h-ft²·F
² Fraction of incident solar radiation

ENERGY STAR Phase 2 provides no performance guidelines for impact-resistant windows and doors.

STYLEVIEW WINDOWS AIR, STRUCTURAL, WATER PERFORMANCE

Window Type	Size	Air Infiltration @ 1.57 PSF	Water PSF	Structural PSF	Structural Class	Florida Certification Number
Single-Hung	36 x 80	0.11	7.50	37.5	DP25	—
	48 x 72	0.10	7.50	45.0	DP25	—
	36 x 72	0.10	7.50	52.5	DP35	15081
	48 x 72*	0.10	7.50	75.0	DP50	8114
Twin Single-Hung (Continuous Head & Sill)	72 x 72	0.11	5.25	37.5	DP35	15140
Double-Hung	36 x 62	0.12	7.50	37.5	DP25	—
	48 x 72	0.12	7.50	37.5	DP25	—
	44 x 72*	0.12	7.50	75.0	DP50	10385
Casement	36 x 72	0.01	7.50	52.5	DP35	15153
	36 x 72*	0.01	7.50	75.0	DP50	15153
XO Slider	72 x 60	0.05	3.75	37.5	DP40	14595
Picture	72 x 96	0.00	7.50	52.5	DP35	15141
	72 x 72	0.00	7.50	75.0	DP50	8197
OX HD Sliding Door	96 x 96	0.12	7.50	75.0	DP50	16605
XX HD Sliding Door	96 x 96	0.02	7.50	75.0	DP50	16605
O XO HD Sliding Door	144 x 96	0.07	6.89	75.0	DP45	16605
O XO** HD Sliding Door	144 x 96	0.07	7.50	75.0	DP50	16605
O X XO HD Sliding Door	192 x 96	0.10	6.89	75.0	DP45	16605
O X XO** HD Sliding Door	192 x 96	0.10	7.50	75.0	DP50	16605

* Reinforced
** With sill dam extender

STYLEVIEW WINDOWS AND DOORS THERMAL PERFORMANCE

To determine thermal performance ratings, enter product specifications in



4234 Ocmulgee Blvd East
Macon, Georgia 31217
p: 866-348-9091
f: 478-744-6221
www.ykkap.com/residential

ENERGY STAR is a registered trademark of the U.S. Environmental Protection Agency. TEFLON is a registered trademark of E.I. du Pont de Nemours and Company.
© 2017 YKK AP America Inc.