

YKK ap[®]

www.ykkap.com



Highwoods One - Glen Allen, VA

YWW 40 T

High Performance, Thermally Broken Window Wall System

The **YWW 40 T** is designed to meet the performance requirements of window walls for multi-story buildings. Glass is set to the front to maximize thermal performance and may be glazed from either the interior of the building for labor savings or from the exterior at column line applications. The system is thermally broken by YKK AP's patented MegaTherm[®] technology.

- Thermally broken Sill Flashing
- Separate Interior/Exterior Finish Options
- Integrates with our YKK AP Entrances

Configuration:

Glazing	Glass Setting	Installation
Inside	Front Set	Screw Spline

Thermal Values:

U-Factor:	Values as low as 0.40*
CRF:	Minimum 73 _{frame} 59 _{glass}

*Based on Imaging. Lower values may be achieved through further simulation.



YWW 40 T SPECS		
Base Depth	4"	
Sightline	2"	
Config	Inside Glazed / Front Set	
Tested Glass	1" IGU with Low-E (C.O.G. U-Factor: 0.29)	
Test	Results	Standards
Air Infiltration	0.06 CFM/FT ² (1.10 m ³ /h-m ²) @ 6.24 PSF (299 Pa)	ASTM E 283
Water Infiltration	Static: 12 PSF (575 Pa) Dynamic: 12 PSF (575 Pa)	ASTM E 331 AAMA 501
Acoustical (1" IGU)	Laminated STC: 35 Laminated OITC: 29	ASTM E 90 ASTM E 1425

Thermal Performance		
Mullion Depth	CRF	
2" x 4"	73	59
	Frame	Glass
AAMA 1503		

Finish Options	
Type	Standard
Factory Anodized	AAMA 612
Organic Paints	AAMA 2604 AAMA 2605

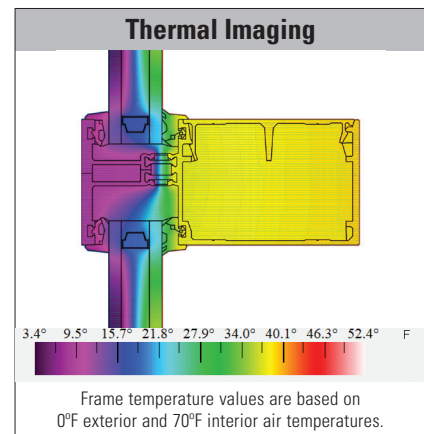

Test numbers are from the YWW 45 T system. YWW 40 test results should be similar.

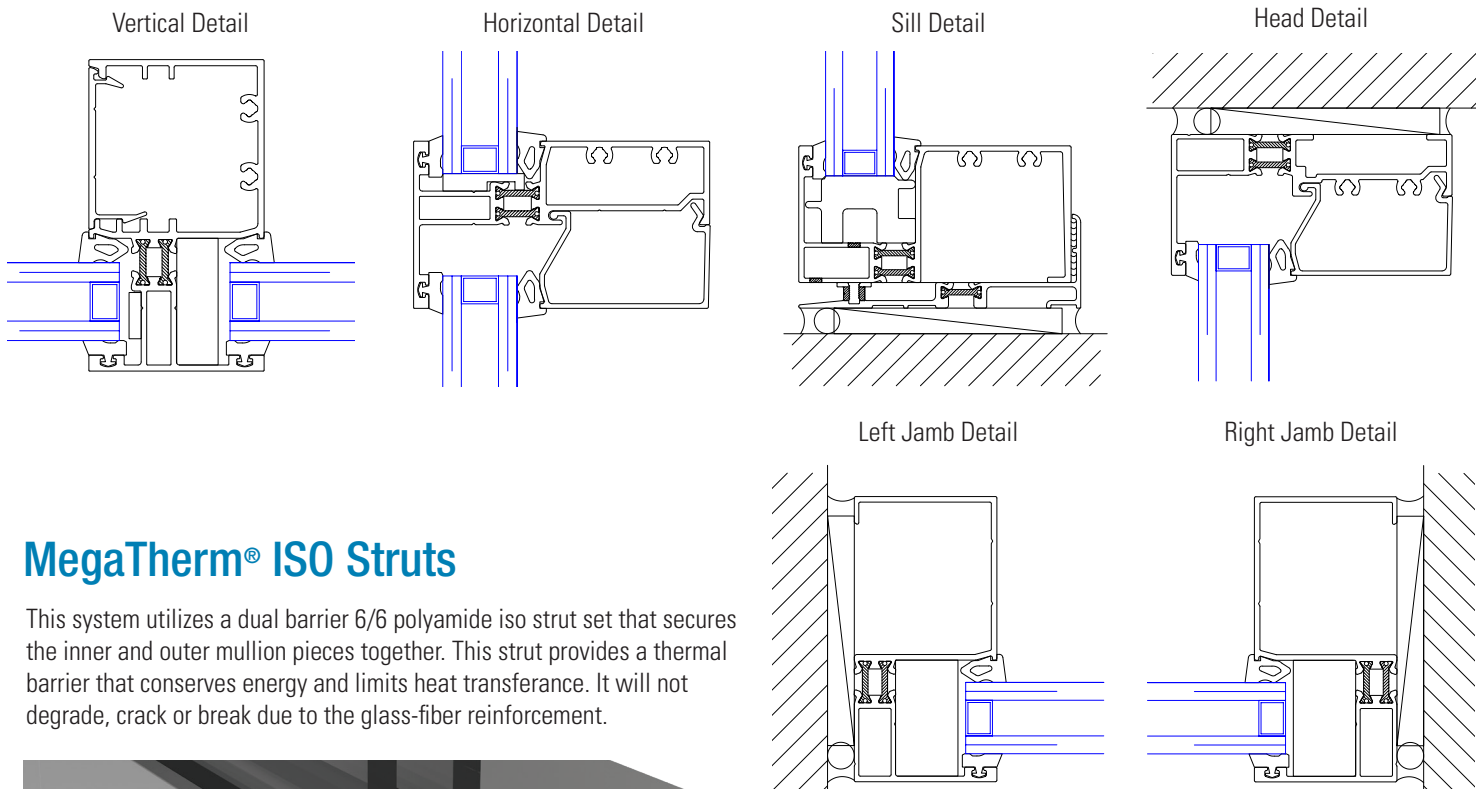

MegaTherm® ISO Struts

This system utilizes a dual barrier 6/6 polyamide iso strut set that secures the inner and outer mullion pieces together. This strut provides a thermal barrier that conserves energy and limits heat transference. It will not degrade, crack or break due to the glass-fiber reinforcement.

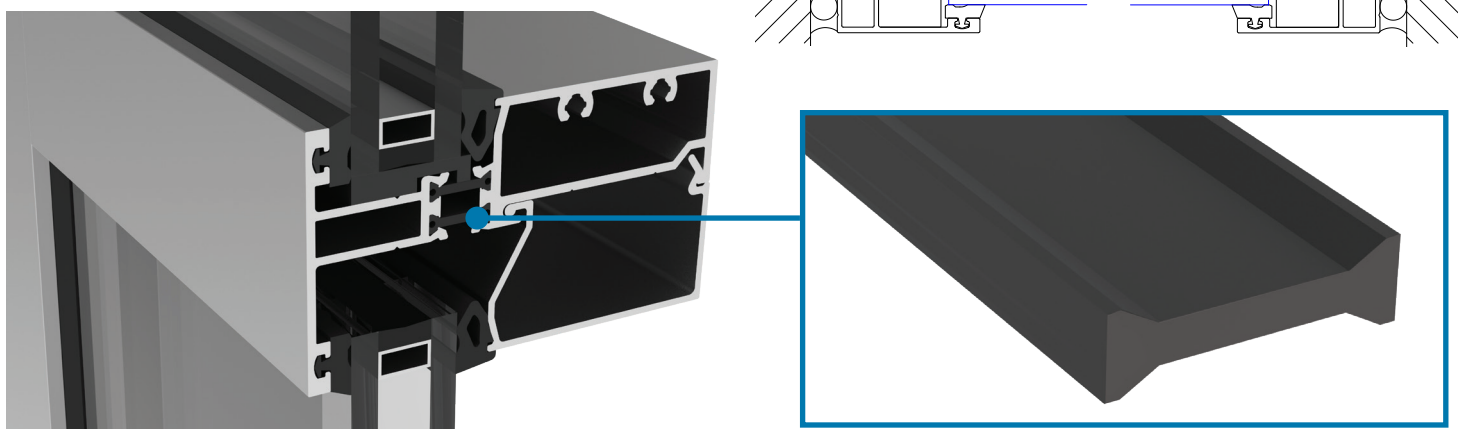

Additional information including CAD details, CSI specs, test reports and installation instructions are found on the Product Guide by clicking this link or visiting www.ykkap.com/commercial/productguide