

YWE 60 T

Thermally Improved, Front Loading Window Wall System

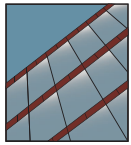

WINDOW WALL SYSTEM

Product Description

The YWE 60 T is a thermally improved window wall system designed and engineered to meet the design challenges of today's new buildings. The system is capable of spanning from floor to floor, even at higher design loads. Snap-on face covers enable separate interior/exterior finishes for aesthetic and/or economic reasons. The system is glazed from the interior to reduce field labor with options for outside re-glazing. Optional head and sill anchors allow ease of installation for punched openings. Two sided structural silicone glazing at vertical mullions is also available as an option.

Product Options & Features

- 2-1/4" Face by 6" Overall Depth
- Inside Glazed to Reduce Field Labor
- Screw Spline or Shear Clip Construction
- Two Piece Interior Glass Stop to Improve Performance
- Optional Structural Silicone Glazed Intermediate Verticals
- Separate Interior/Exterior Finish Options
- Thermal Clips help reduce heat transfer

U-Factor Values as low as 0.39*

CRF Minimum 59_{frame} & 62_{glass}

*Based on AAMA 507. Lower values may be achieved through further simulation.



Quality
inspires®

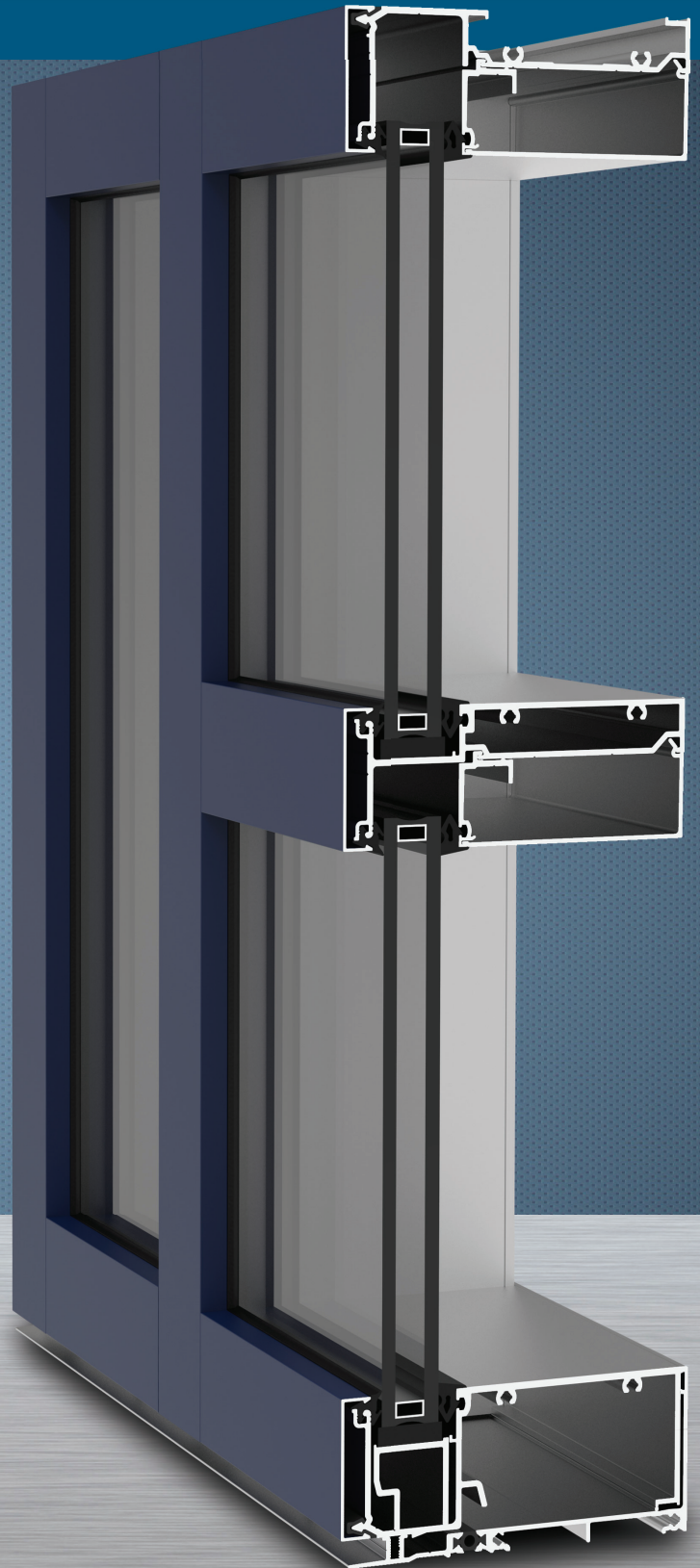

SYSTEM SPECIFICATIONS

System Sightline	Base Depth	Glazing & Config	Glass	Air Infiltration	Water Infiltration	Acoustical Performance
2-1/4"	6"	Inside & Front Set	1" IGU with Low-E (C.O.G. U-factor: 0.29)	0.06 CFM/FT ² (1.10 m ³ /h·m ²) @ 6.24 PSF (299 Pa)	Static: 15 PSF (719 Pa) Dynamic: 15 PSF (719 Pa)	Std STC: 31 Std OITC: 26
						Lam STC: 34 Lam OITC: 28
Testing Standards				ASTM E 283	ASTM E 331 & AAMA 501	ASTM E 90 & 1425
Installation Options				Continuous Head and Sill, Vertical Through or Screw Spline with Monolithic or Insulating Glass		
Available Finishes				Factory Anodized (AAMA 612) and Organic Paints (AAMA 2604 & AAMA 2605)		

Thermal Performance						
1" IGU	BTU/hr·ft ² ·°F					
C.O.G U-Factor	0.30	0.28	0.26	0.24	0.22	0.20
2-1/4" x 6"	0.47	0.45	0.43	0.42	0.40	0.39
Testing Standards	AAMA 507					

CRF	
Frame	Glass
59	62
AAMA 1503	

VERTICAL/HORIZONTAL DETAILS

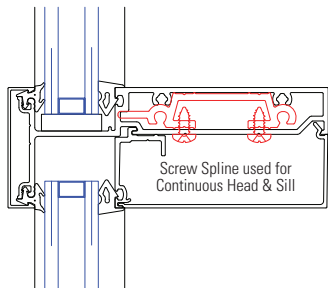

Horizontal Detail

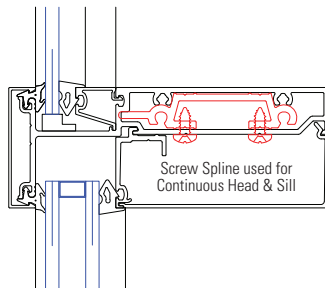

1/4" Glazing over 1" Glazing
Horizontal Detail

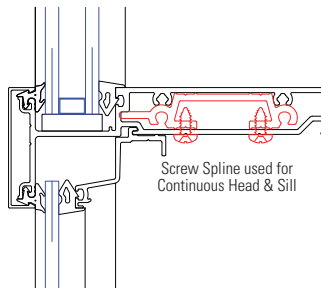

1" Glazing over 1/4" Glazing
Horizontal Detail

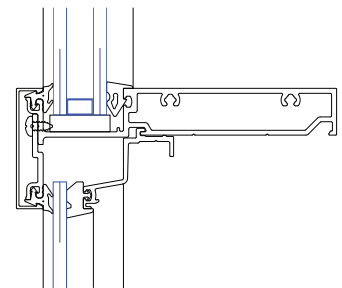

1" Glazing over 1/4" Re-glazing
Horizontal Detail

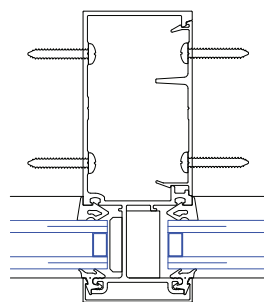

Vertical Detail

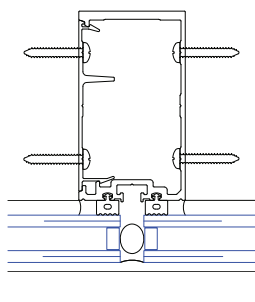

SSG Vertical Detail

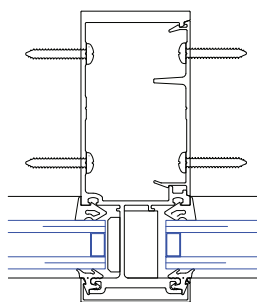

Heavy Duty
Vertical Detail

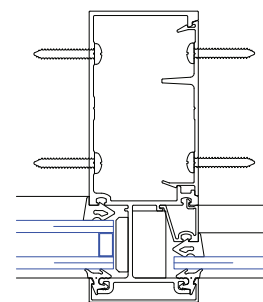

1" Glazing next to 1/4" Glazing
Vertical Detail

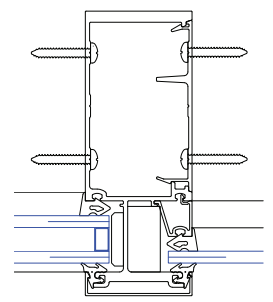

1" Glazing next to 1/4" Glazing
Heavy Duty Vertical Detail

Additional information including CAD details, CSI specifications, Test Reports and Installation instructions are available online at:

www.ykkap.com/commercial/product/window-walls/ywe-60-t/