

YFW 400 TU

Thermally Broken Fixed Window for Insulating Glass



FIXED WINDOWS

Elegant Simplicity and Efficiency

The YFW 400 TU thermally broken fixed windows are fully tested in accordance with AAMA standards achieving an AW rating. This fixed window was designed and engineered to be elegant with a 1-13/16" sightline and to be efficient with superior air and water performance. Thermal U-factors range from 0.34 to 0.56 with common Low E, and Air and Argon filled IGU's with spacers.

Benefits of Performance

The YFW 400 TU performance can be integrated into smaller storefront and window wall punched opening applications. This contributes to LEED designs by optimizing energy performance as well as day-lighting and views to the outdoor environment. Along with the simple installation, the YFW 400 TU becomes the choice product for your next sustainable design.

Versatility

The 4" depth design of YFW 400 TU Fixed Window integrates easily with YSW 400 T Horizontal Sliding Window, YVS 400 TU and YVS 410 TU Hung Window Systems using the same stacking mullions. YFW 400 TU meets the many design challenges required in remodeling, retrofitting, and new construction.

U-Factor Values as low as 0.34*

CRF Minimum 67_{frame} & 71_{glass}

*Based on AAMA 507. Lower values may be achieved through further simulation.



Quality
inspires®

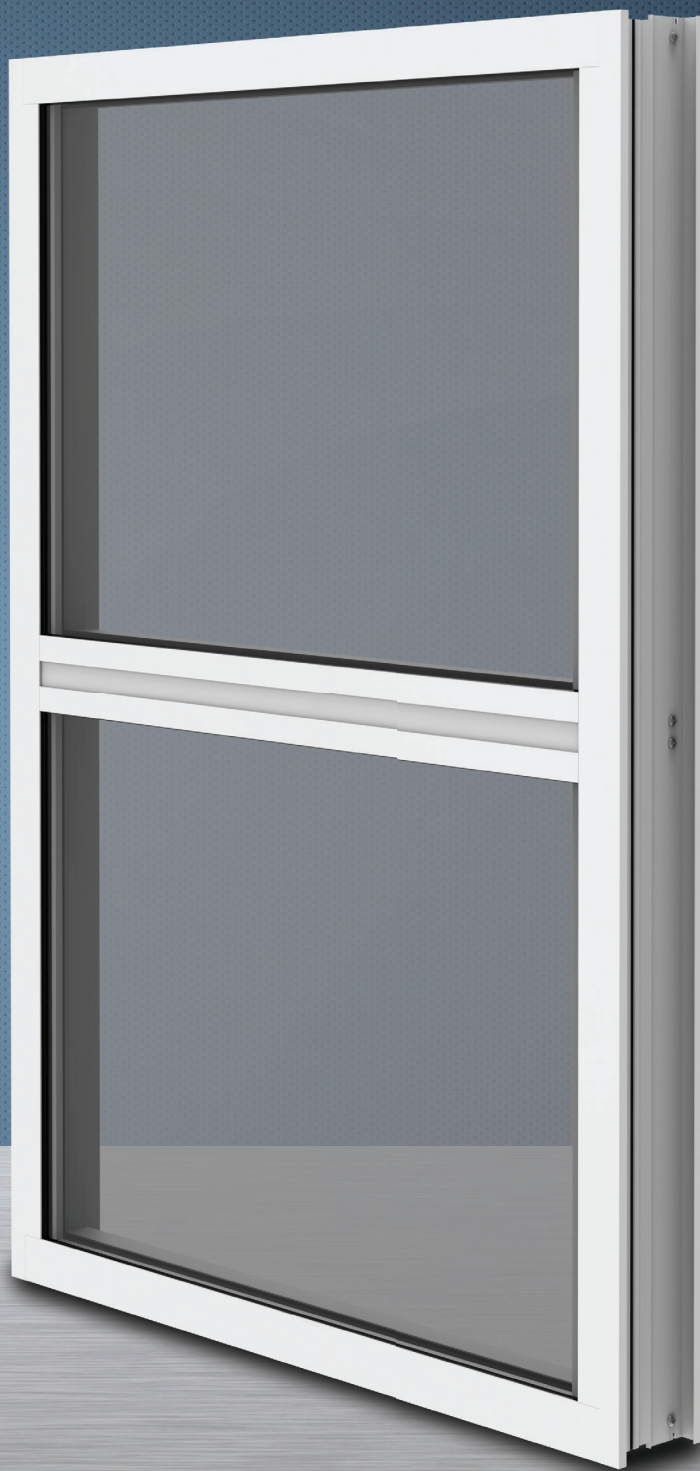

YFW 400 TU

SYSTEM SPECIFICATIONS

System Sightline	Base Depth	Glazing & Config	Glass	Air Infiltration	Water Infiltration	Acoustical Performance
1-13/16"	4"	Laminated Pre-Glazed & Fixed	1" IGU with Low-E (C.O.G. U-factor: 0.29)	0.10 CFM/FT ² (5.5 m ³ /h·m ²) @ 6.24 PSF (299 Pa)	Static: 15 PSF (719 Pa)	Lam STC: 38 Lam OITC: 30
Testing Standards				ASTM E 283	ASTM E 331 & AAMA 501	ASTM E 90 & 1425
Structural Performance				AAMA Certified AW Performance Grade 100 for Fixed Window - ASTM F 842 and TAS 202		
Available Finishes				Factory Anodized (AAMA 612) and Organic Paints (AAMA 2604 & AAMA 2605)		

Thermal Performance						
1" IGU			BTU/hr·ft ² ·°F			
C.O.G U-Factor	0.30	0.28	0.26	0.24	0.22	0.20
1-13/16" x 4"	0.42	0.41	0.39	0.37	0.36	0.34
Testing Standards	AAMA 507					

CRF	
Frame	Glass
67	71
AAMA 1503	

MULLION OPTIONS & CONFIGURATIONS

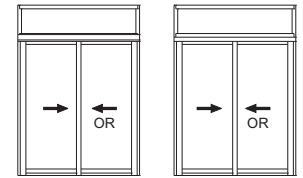
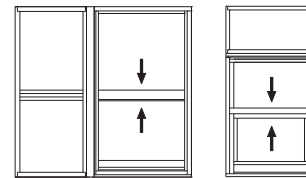
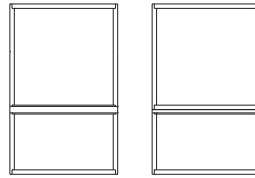
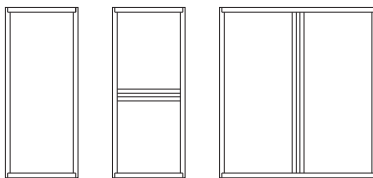
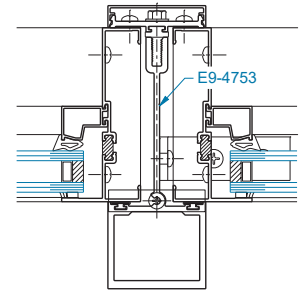
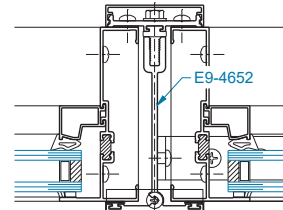
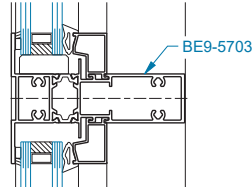
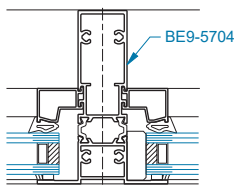

FEATURES & BENEFITS

- Certified AAMA Performance Grade: AW-PG100-FW
- ThermaBond Plus® Thermal Break
- 1" Insulating Glazing or Insulating Panels

- Integral Vertical and Horizontal Mullions (Non-Impact)
- Vertical and Horizontal Stacking Mullion Options
- Head/Jamb Receptors, Box Trim, Sill Flashing, Panning, and Multiple Anchor Options

YFW 400 TU Design Features

- ▶ Equal Legs on Frame for Easy Installation in New Construction or Renovations
- ▶ Interlocking Mechanically Fastened Aluminum Bead Glazing (LMI Wet/SM Dry)
- ▶ ThermaBond Plus® Thermal Break for Superior Thermal Performance
- ▶ 1" Glazing – IGU's or Insulating Panels

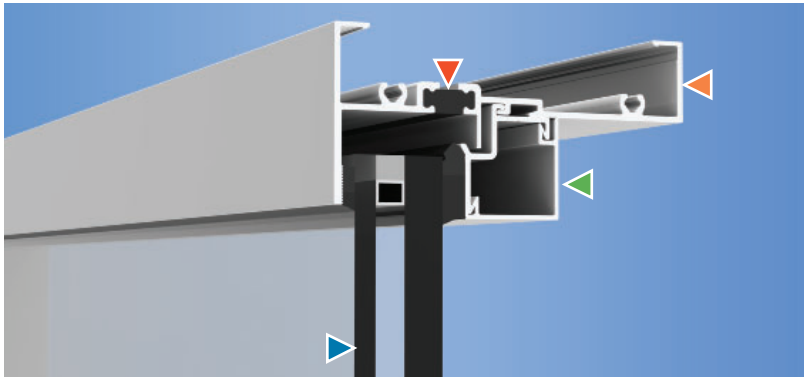

Additional information including CAD details, CSI specifications, Test Reports and Installation instructions are available online at:
www.ykkap.com/commercial/product/architectural-windows/yfw-400-tu/