

**TABLE OF CONTENTS**

**YSD 400 SLIDING DOOR**

**STANDARD CONFIGURATIONS ..... Page 2**

**YSD 400 SLIDING DOOR MEMBERS (1/4 SIZE)..... Page 3 to 7**

**YSD 400 SLIDING DOOR FRAME OPTIONS (1/2 SIZE)..... Page 8**

**YSD 400 SLIDING DOOR SCREEN DETAILS (1/4 SIZE) ..... Page 9 to 10**

**YSD 400 HARDWARE & ACCESSORIES..... Page 11**

**SIZE LIMITATIONS / WIND LOAD CHARTS ..... Page 12 to 13**

\*The latest installation instructions for this product are available at [www.ykkap.com](http://www.ykkap.com).

**YSD 400 STANDARD CONFIGURATIONS**

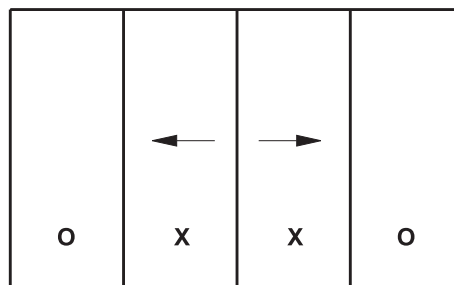
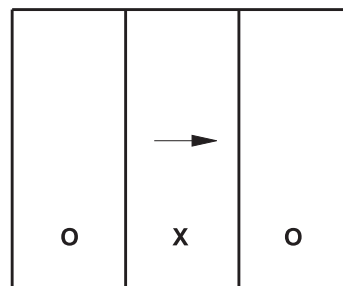
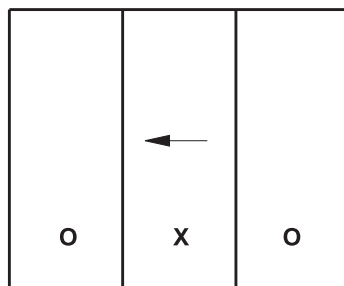
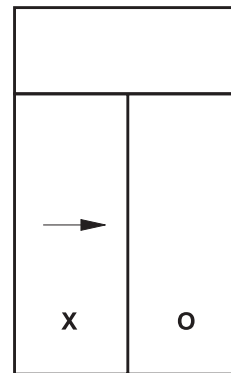
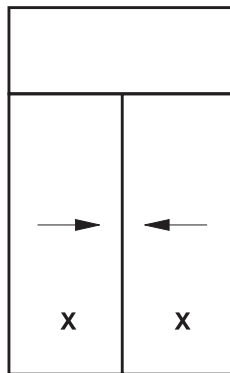
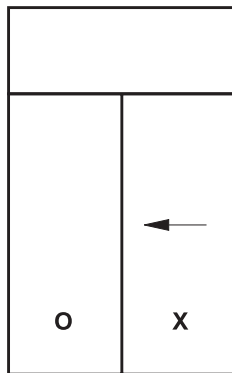
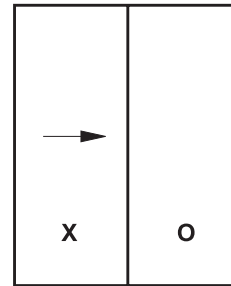
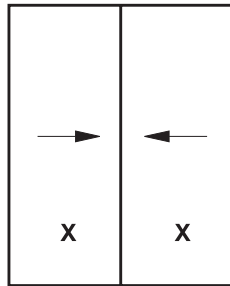
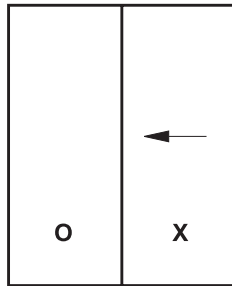

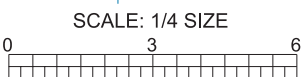
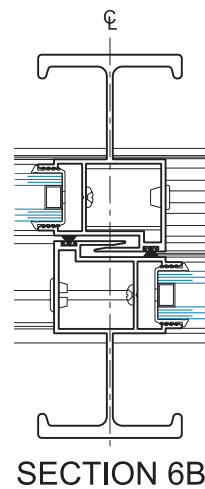
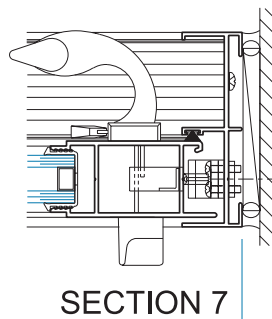
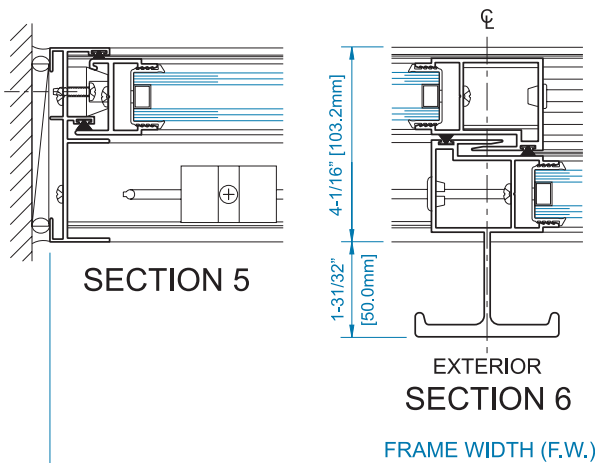
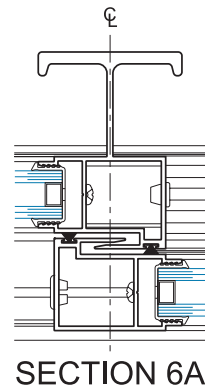
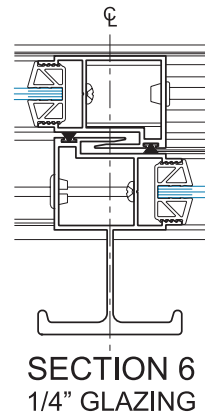
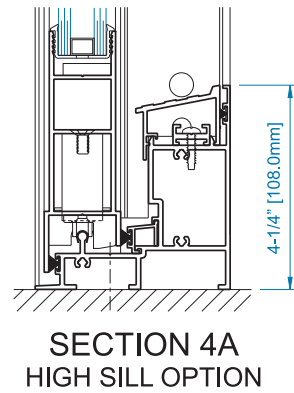
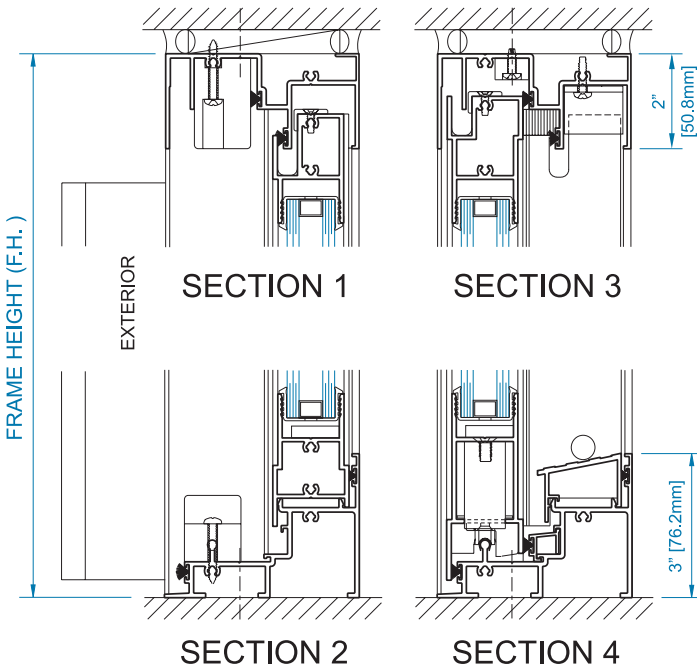
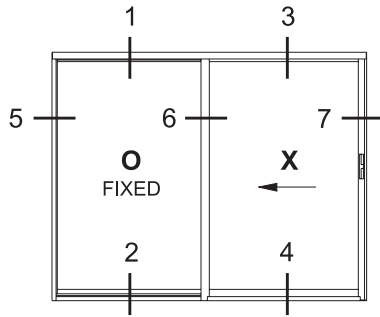

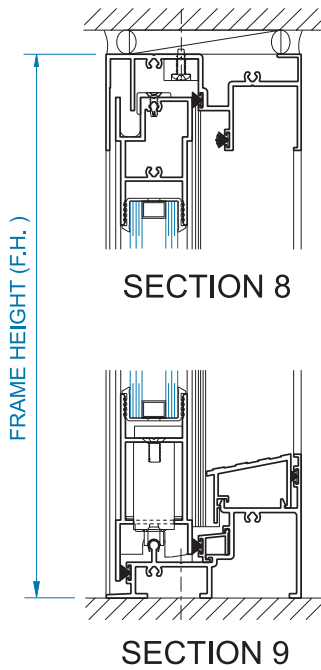
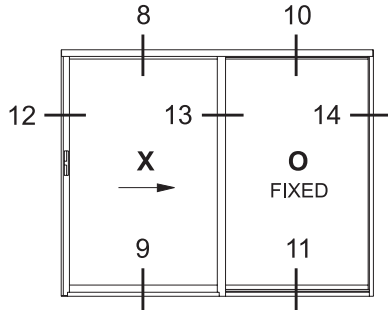

SECTION 8

SECTION 9

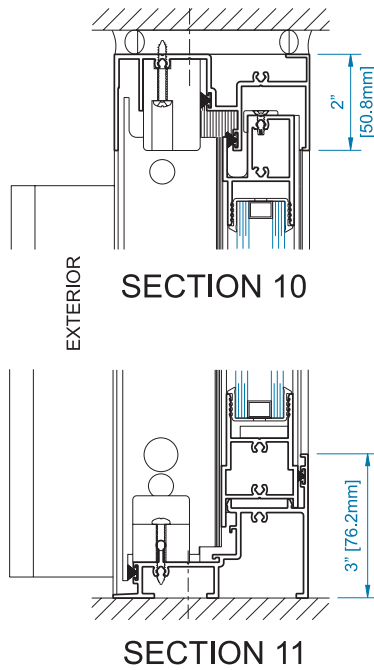

SECTION 10

SECTION 11

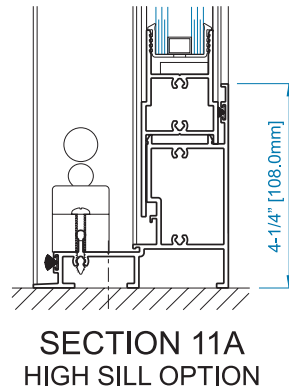

SECTION 11A  
HIGH SILL OPTION

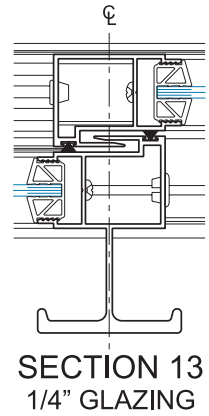

SECTION 13  
1/4" GLAZING

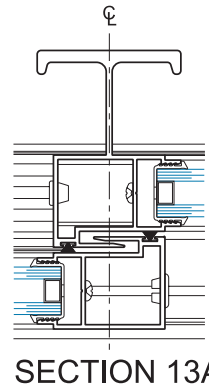

SECTION 13A

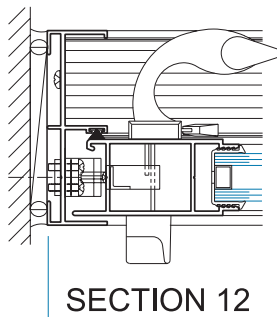

SECTION 12

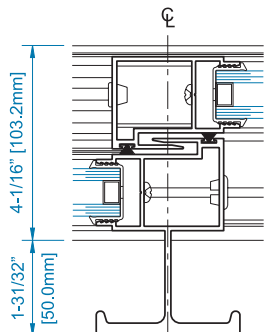

EXTERIOR  
SECTION 13

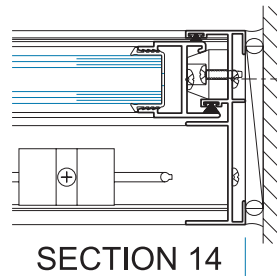

SECTION 14

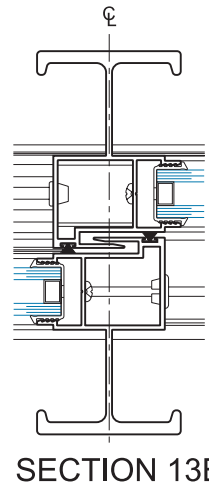

SECTION 13B

FRAME WIDTH (F.W.)

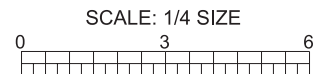

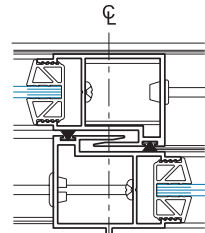
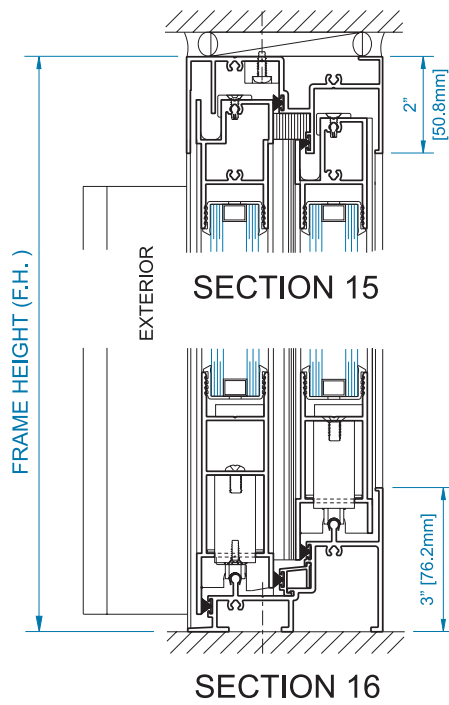
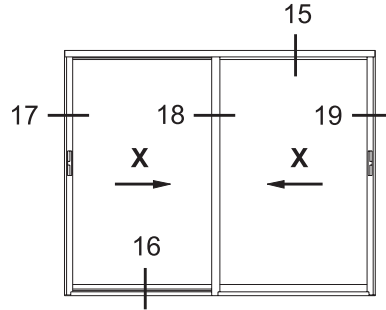

SECTION 18  
1/4" GLAZING

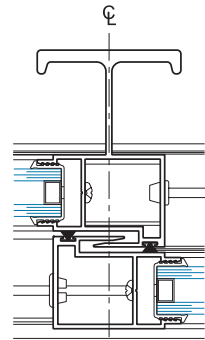

SECTION 18A

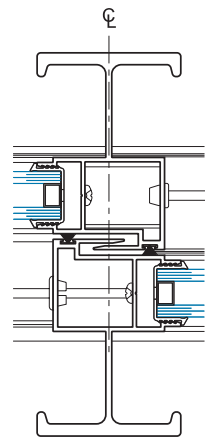

SECTION 18B

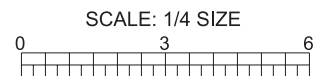
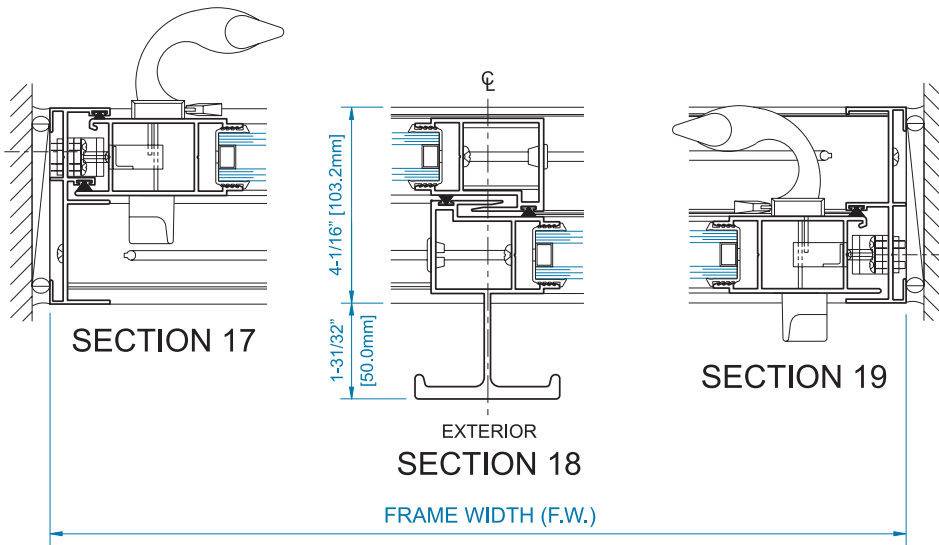

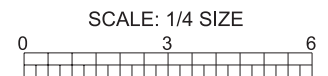
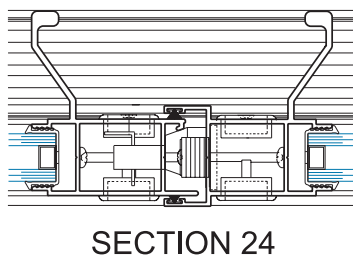
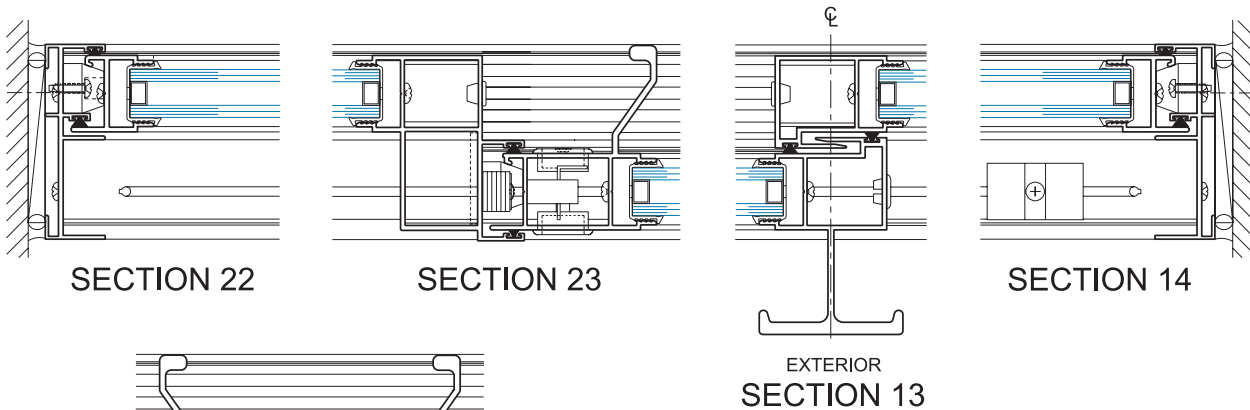
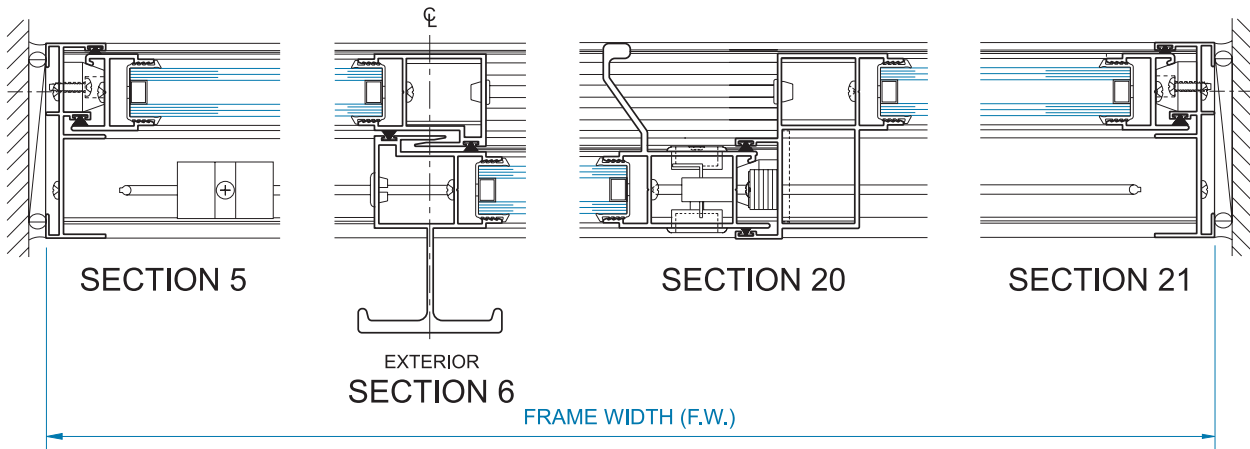
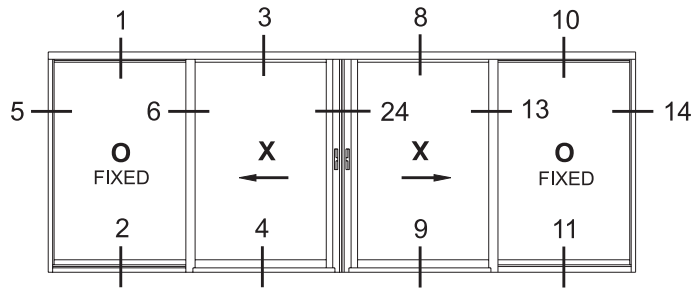
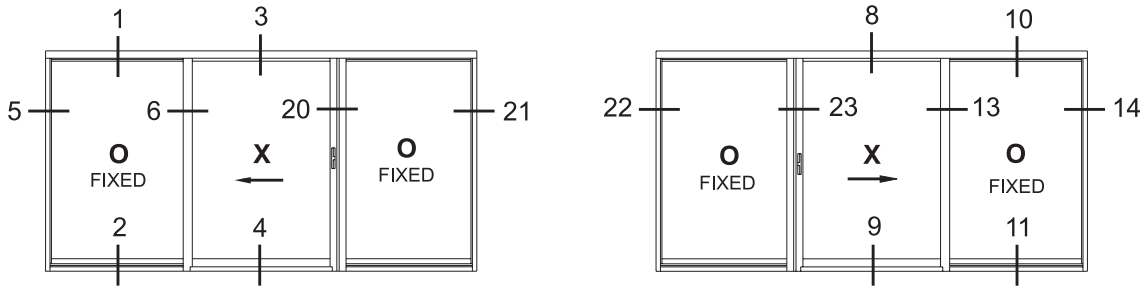

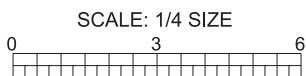
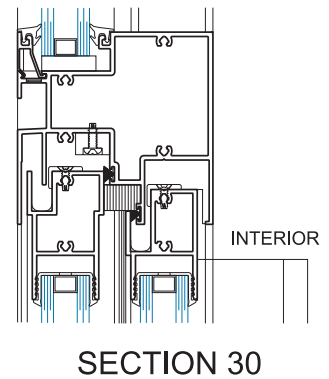
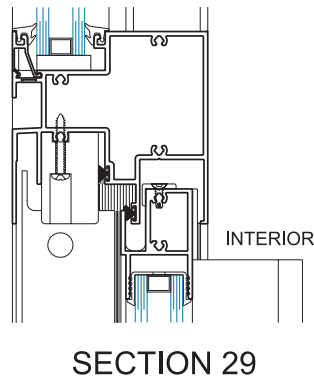
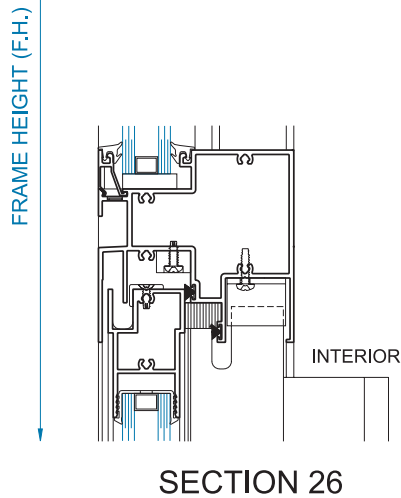
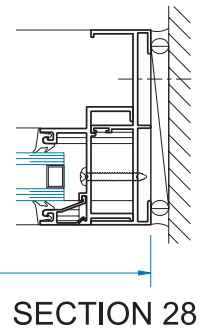
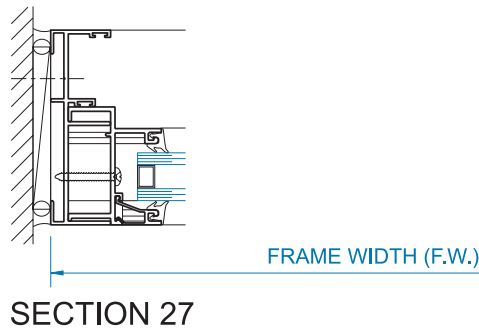
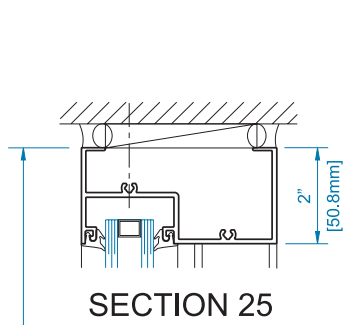
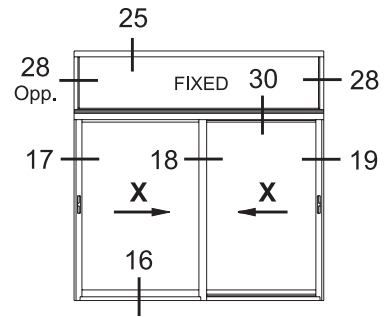
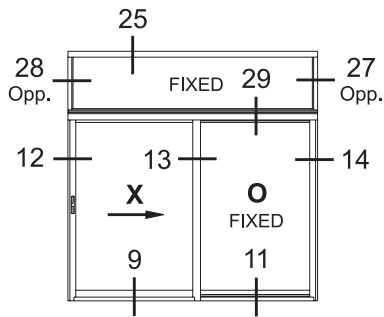
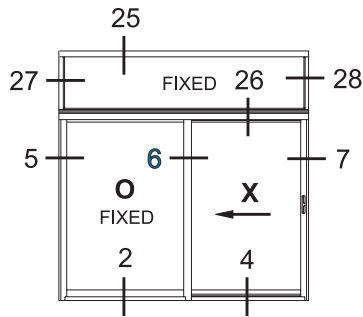

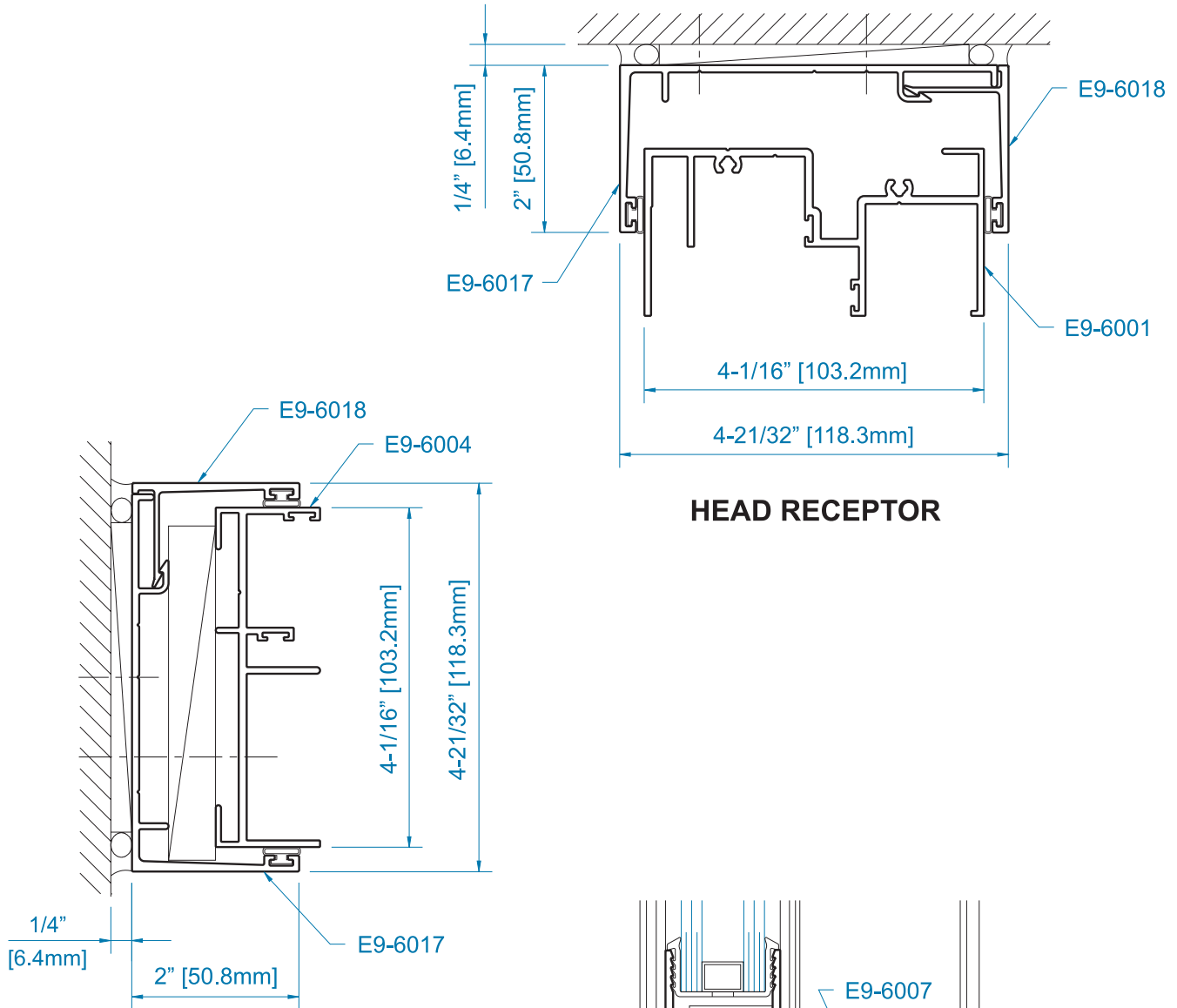

**HEAD RECEPTOR**

**JAMB RECEPTOR**

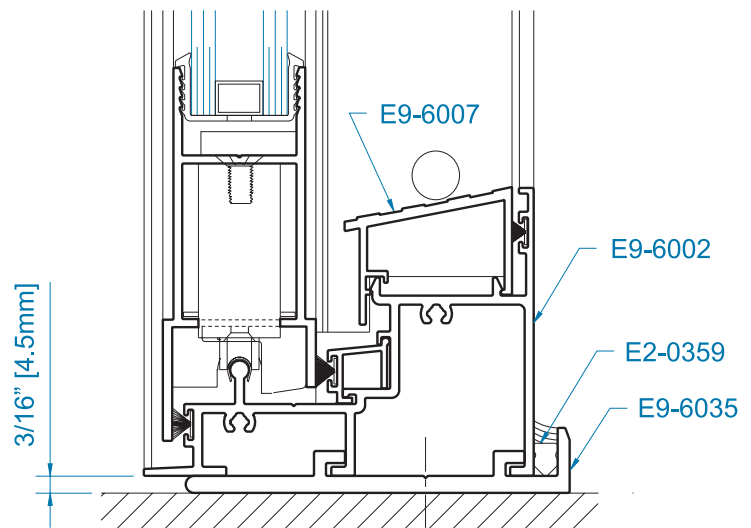

**SILL ANCHOR**

SCALE: 1/4 SIZE

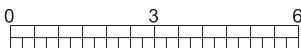

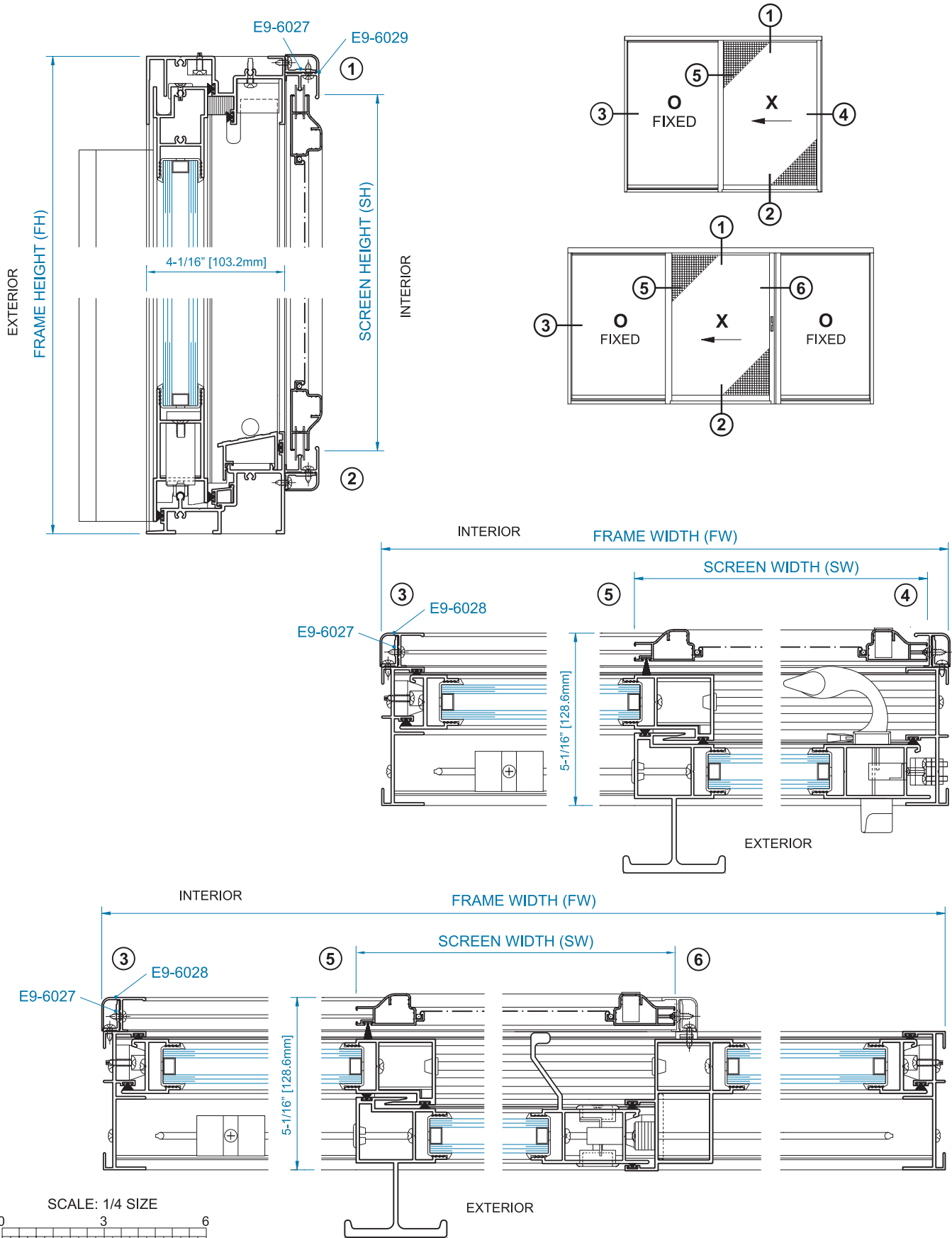

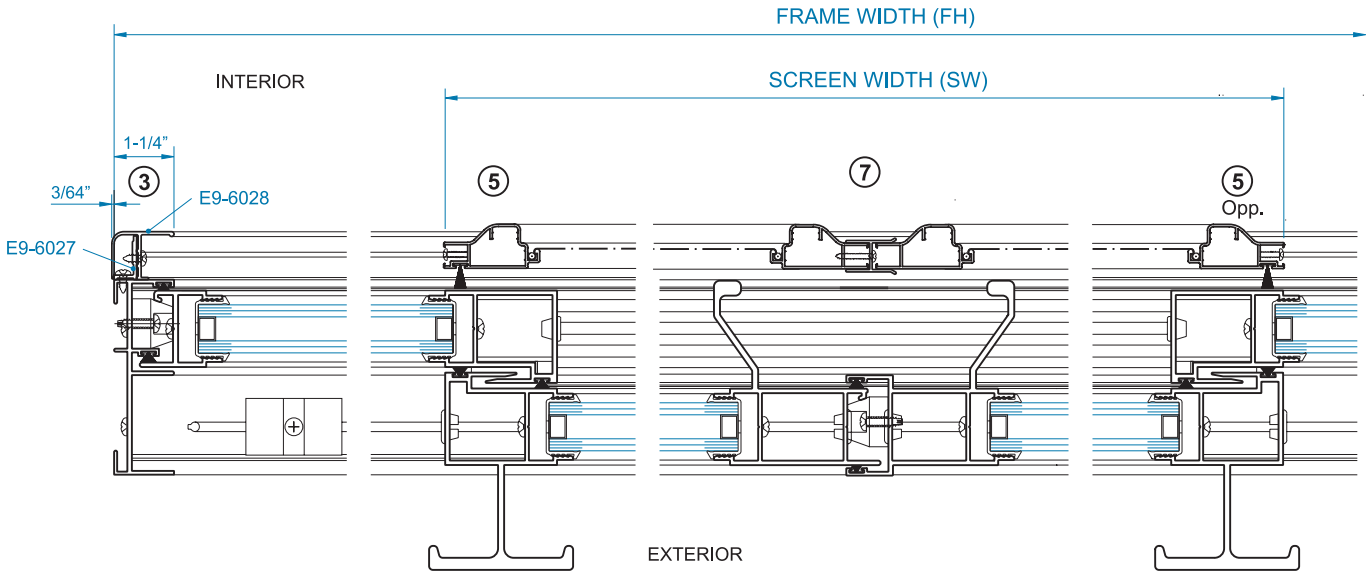
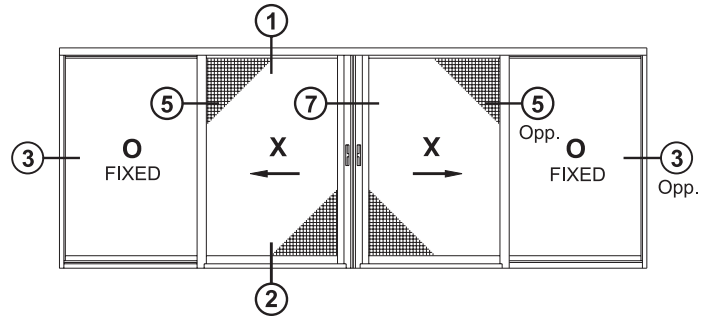
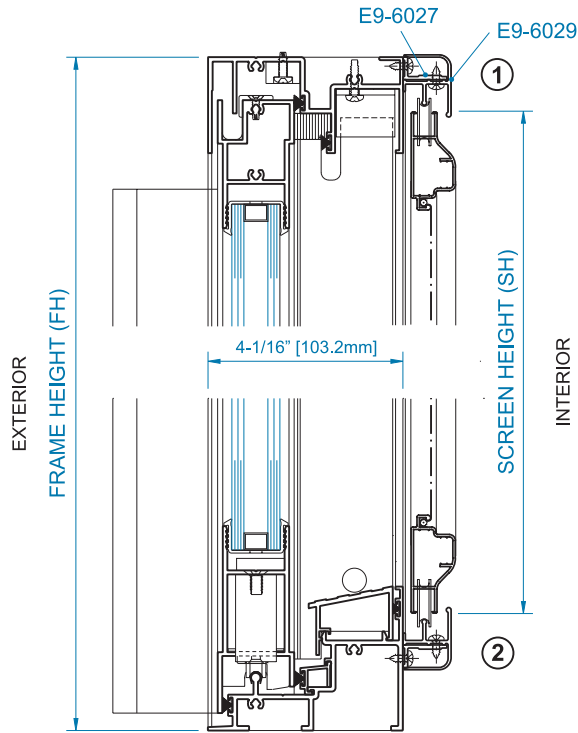

SCALE: 1/4 SIZE

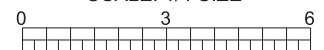

**HARDWARE & ACCESSORIES**

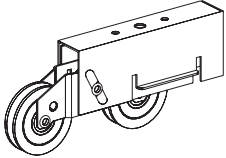
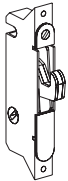
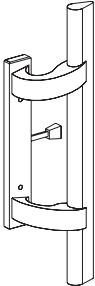
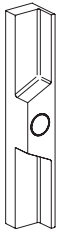
ITEM	DETAIL	DESCRIPTION	MATERIAL
BALL BEARING ROLLER	 <p style="text-align: center;">E1-1616</p>	Adjustable rollers equipped with full race, permanently lubricated ball bearings which are labyrinth shielded to resist contamination by dust and moisture.	STAINLESS STEEL
MORTISE LOCK	 <p style="text-align: center;">E1-1607</p>	W&F Manufacturing 410-4-1001 All steel case with laminated steel hookbolt. Bolt reach is adjustable by turning screw located on the lock face.	ZINC PLATED STEEL
INTERIOR PULL HANDLE	 <p style="text-align: center;">E1-1608</p>	Red oak handle on an aluminum alloy and high impact thermal plastic base. Wood handle is sealed with a clear oil finish. Aluminum base is finished with a black powder coat. Plastic base is black.	WOOD, ALUMINUM ALLOY & PLASTIC
EXTERIOR PULL HANDLE	 <p style="text-align: center;">E1-1609</p>	High pressure Zamac alloy, die cast handle finished in a black powder coat. When a key lock is required, the cast plug for the cylinder may be removed at the factory or in the field during re-rofitting.	ZAMAC ALLOY

## SLIDING DOOR SIZE LIMITATIONS

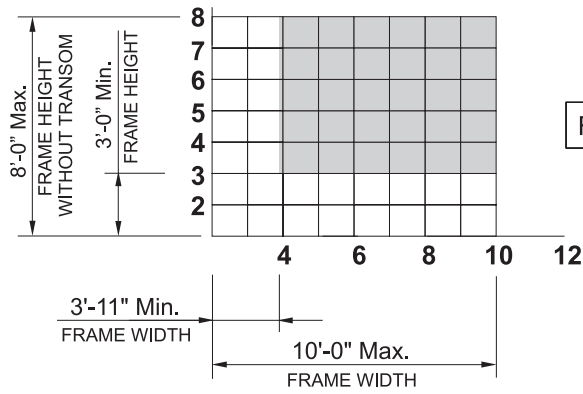
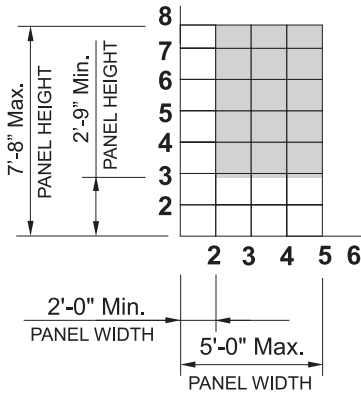

For OX, XO and XX

For OXO, and OXO

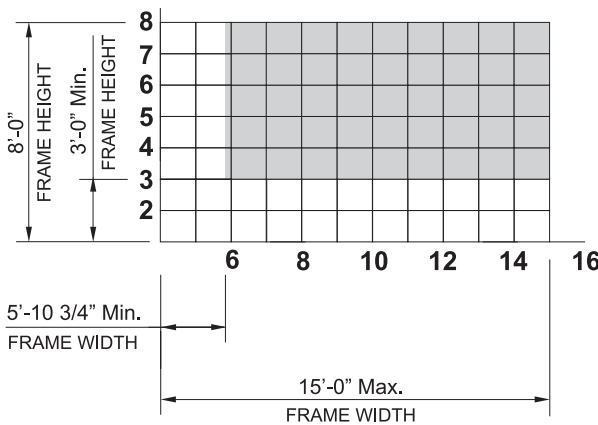

For OXXO

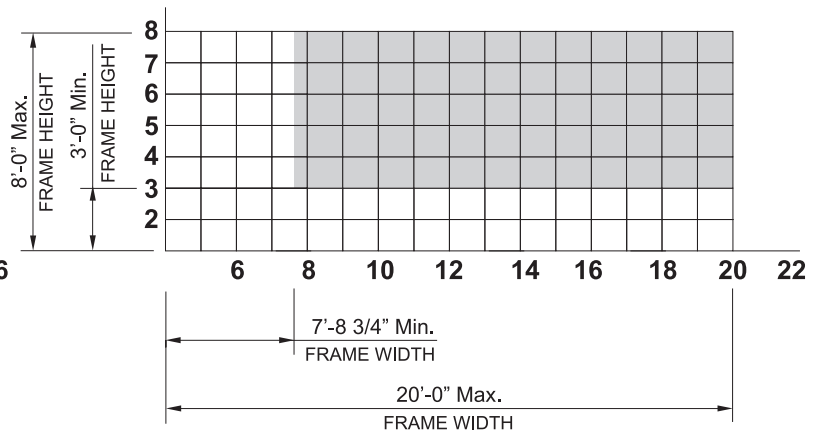

### NOTE:

- Frame width and height should allow 3/4" for width & 1/2" for height overall clearance between the door frame and rough opening. This allows for thermal expansion and easier installation. Shim the door at all anchor locations.
- For door widths greater than 20 feet consult YKK AP Technical Center.
- Transoms are limited to a maximum of:
  - Width = 7'-6"
  - Height = 1'-0"
- For transoms greater than 7'-6" x 1'-0" consult YKK AP Technical Center.

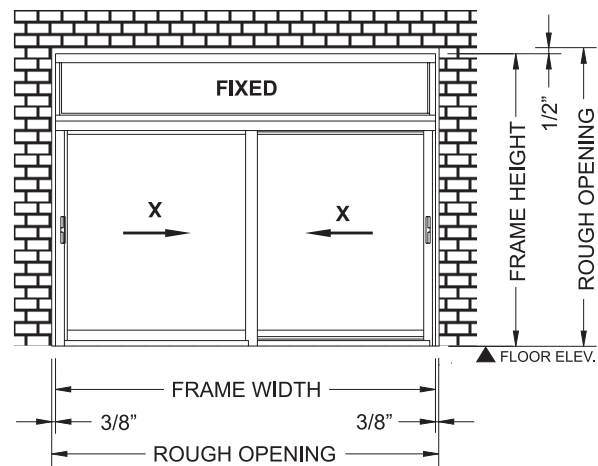

## WIND LOAD CHARTS

### DEFLECTION CRITERIA

L/175 OR 3/4" (19.1mm) MAX.

CODES AND SPECIFICATIONS MAY VARY, NO SINGLE LITE OF GLASS SHALL DEFLECT MORE THAN 3/4" (19.1mm)

### ALLOWABLE WIND LOAD STRESS

YKK AP tested standard. Contact YKK AP for more information.

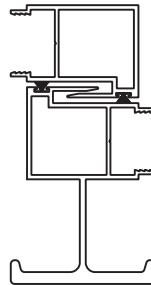
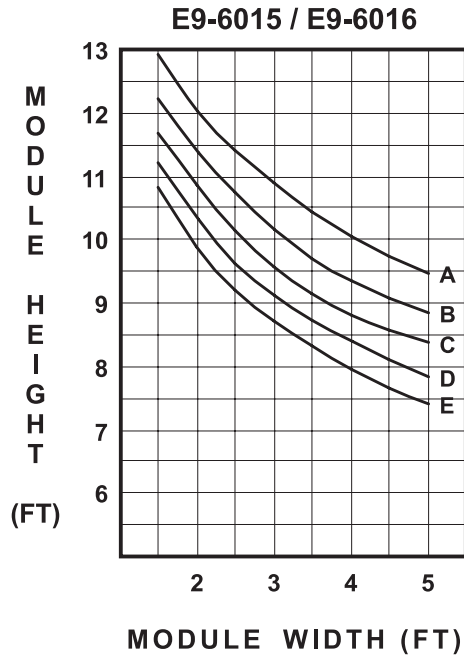

- A=40 PSF (1920 Pa)
- B=50 PSF (2390 Pa)
- C=60 PSF (2870 Pa)
- D=70 PSF (3350 Pa)
- E=80 PSF (3830 Pa)

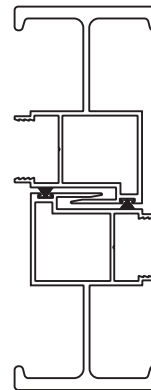
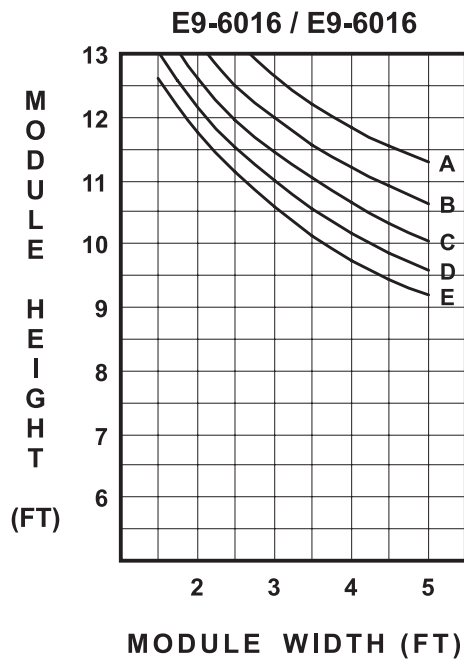
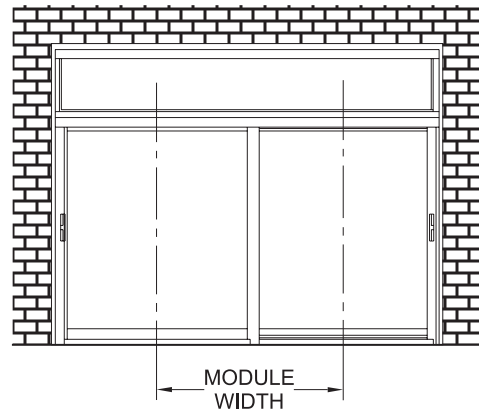

- A=40 PSF (1920 Pa)
- B=50 PSF (2390 Pa)
- C=60 PSF (2870 Pa)
- D=70 PSF (3350 Pa)
- E=80 PSF (3830 Pa)