

**TABLE OF CONTENTS**

**YHS 50 TU THERMAL IMPACT RESISTANT STOREFRONT SYSTEM  
FOR INSULATED GLAZING 2-1/2" x 5"  
[NON-SHUTTERED APPLICATIONS]**

**PICTORIAL VIEW**..... Page 2

**TYPICAL ELEVATIONS** ..... Page 3

**FRAMING MEMBERS (1/4 SIZE)**

**LARGE MISSILE (50 PSF)** ..... Page 4

**LARGE MISSILE (70 PSF)** ..... Page 5

**SMALL MISSILE (70 PSF)**..... Page 6

**INSIDE GLAZING**..... Page 7

**CORNER FRAMING MEMBERS (1/4 SIZE)**..... Page 8

**DOOR FRAMING MEMBERS (1/4 SIZE)** ..... Page 9 to 12

**PREGLAZED FRAMING MEMBERS (1/4 SIZE)**

**OUTSIDE, WET GLAZING** ..... Page 13 to 14

**OUTSIDE, DRY GLAZING**..... Page 15 to 16

**INSIDE, DRY GLAZING** ..... Page 17 to 18

**WIND LOAD CHARTS** ..... Page 19 to 20  
**(NON-DADE COUNTY)**

\*The latest installation instructions for this product are available at [www.ykkap.com](http://www.ykkap.com).

**YHS 50 TU STOREFRONT SYSTEM PICTORIAL VIEW**

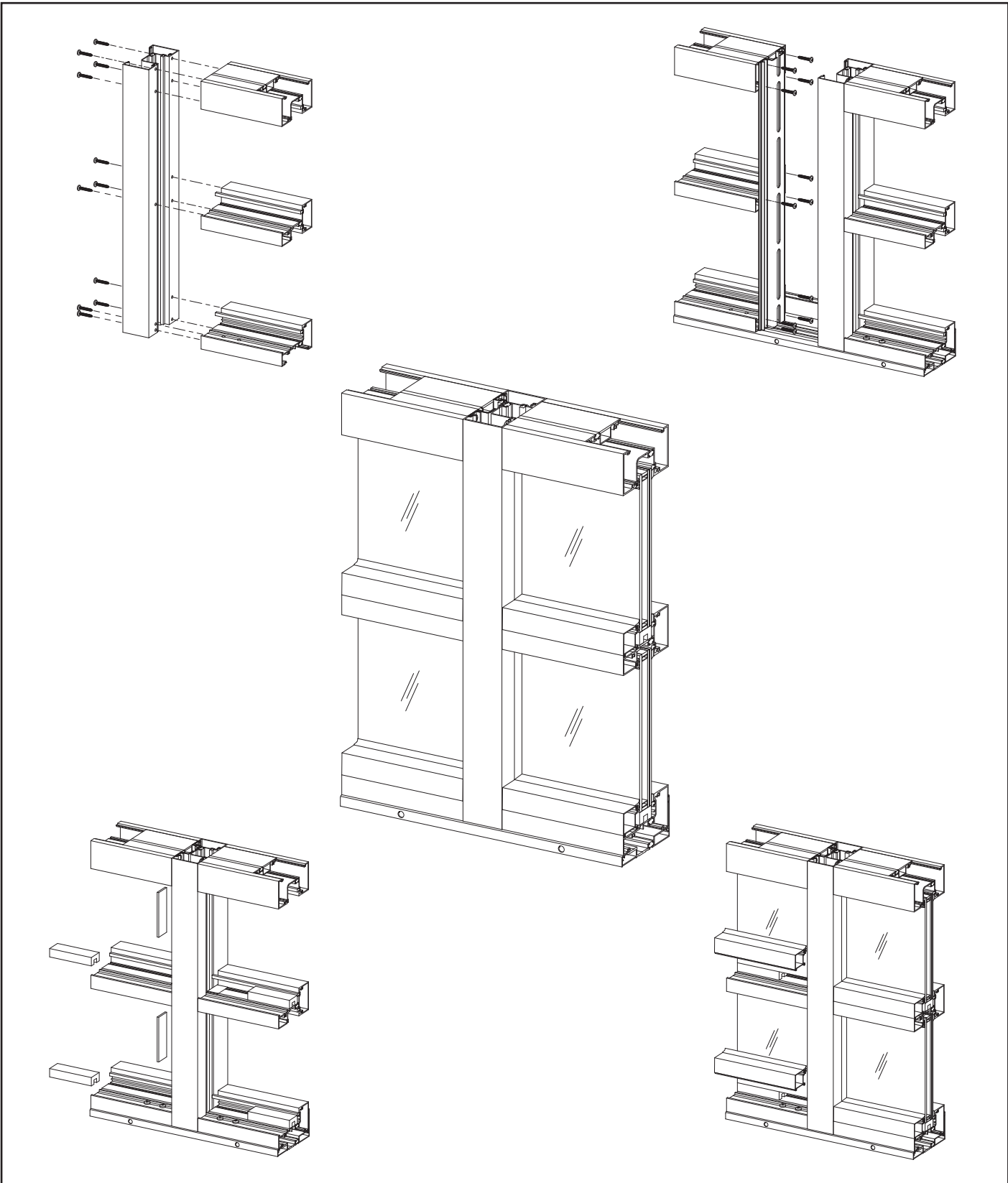

YHS 50 TU AND 35H/35HL DOOR TYPICAL ELEVATIONS

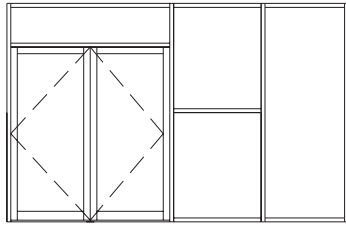

EXAMPLE 1

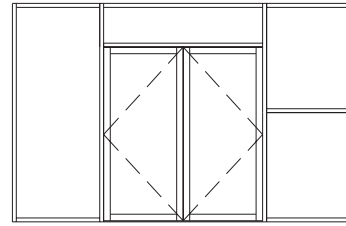

EXAMPLE 2

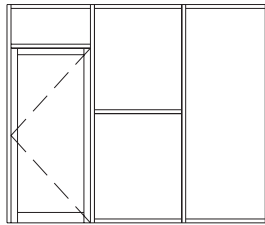

EXAMPLE 3

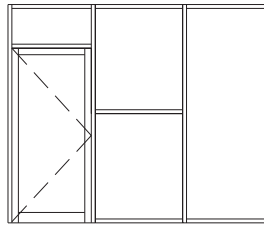

EXAMPLE 4

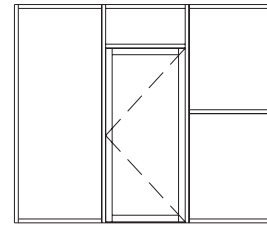

EXAMPLE 5

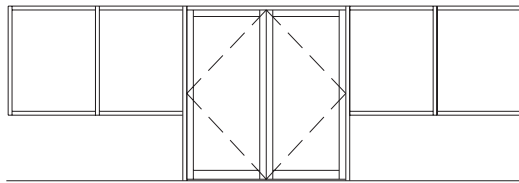

EXAMPLE 6

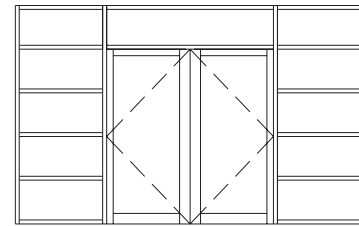

EXAMPLE 7

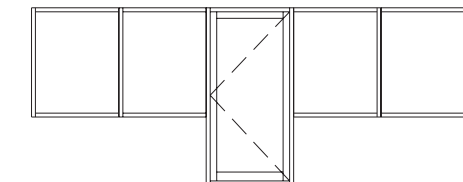

EXAMPLE 8

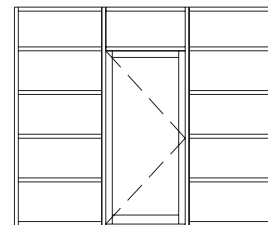

EXAMPLE 9

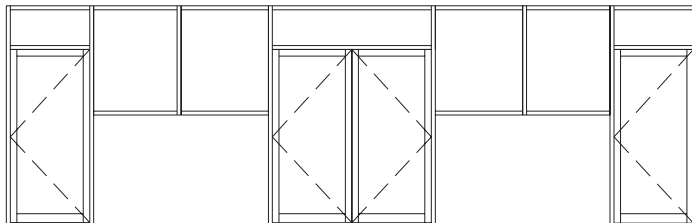

EXAMPLE 10

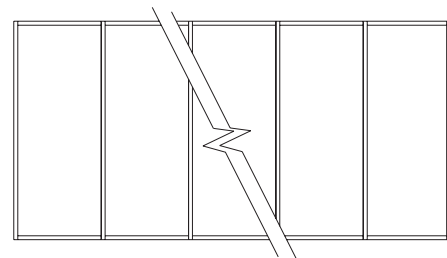

EXAMPLE 11

Other variations are available; please consult with YKK AP.

## YHS 50 TU STOREFRONT FRAMING MEMBERS LARGE MISSILE (STANDARD CONFIGURATION)

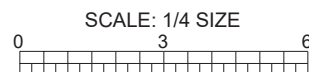
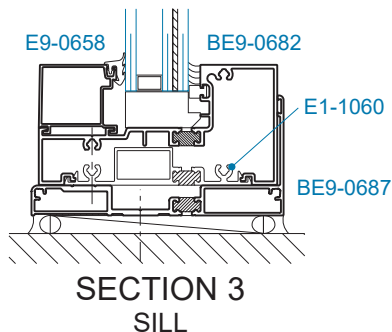
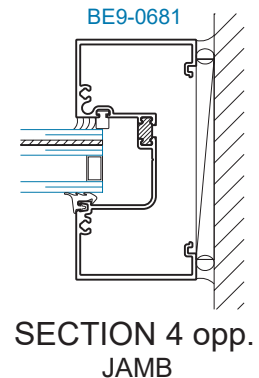
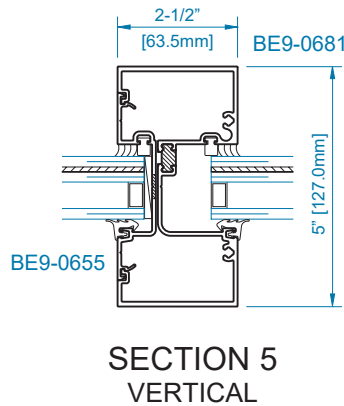
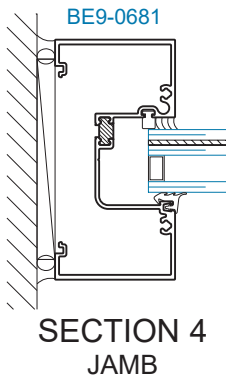
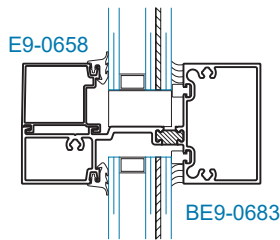
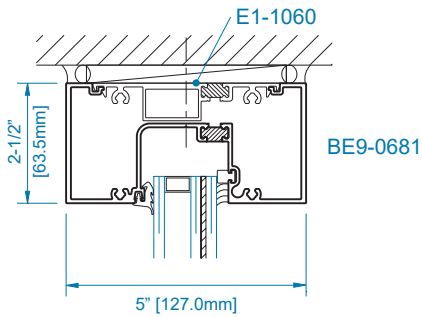
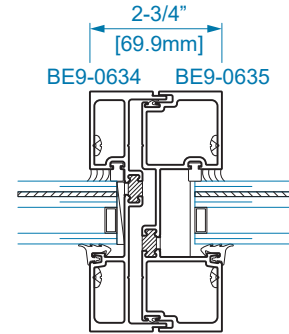
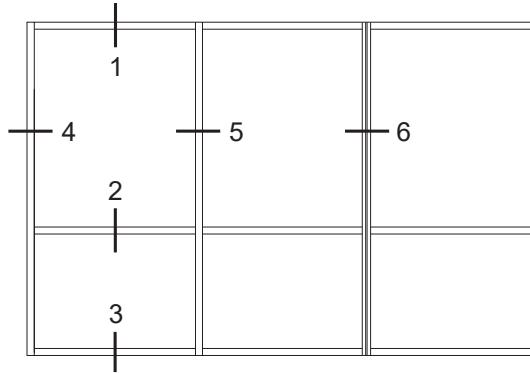

YHS 50 TU STOREFRONT FRAMING MEMBERS  
LARGE MISSILE (HEAVY CONFIGURATION)

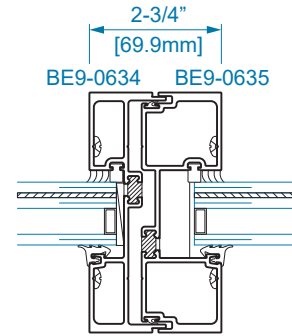
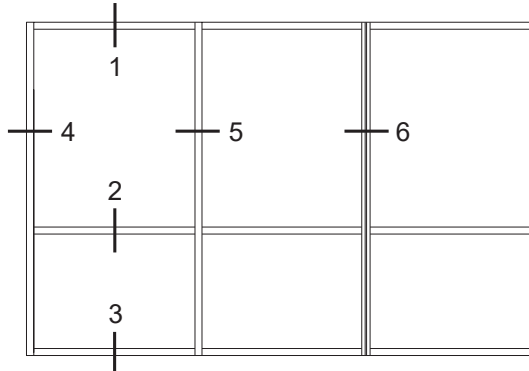

SECTION 6  
EXPANSION  
MULLION

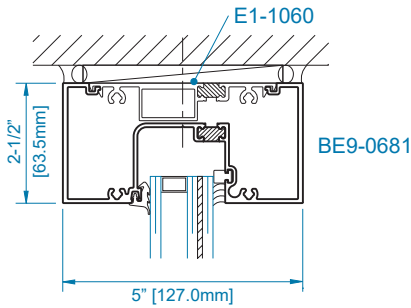

SECTION 1  
HEAD

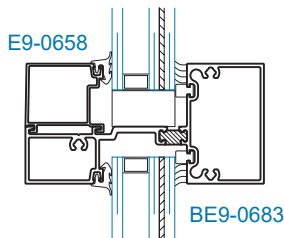

SECTION 2  
HORIZONTAL

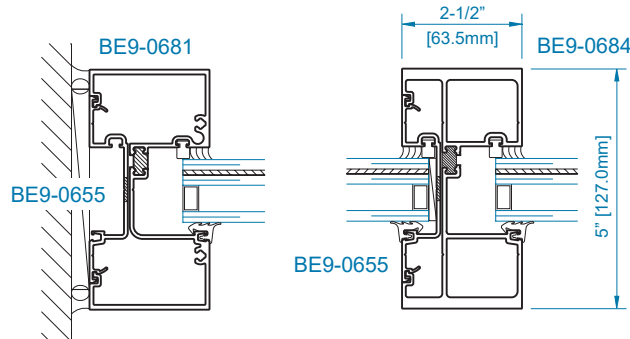

SECTION 4  
JAMB

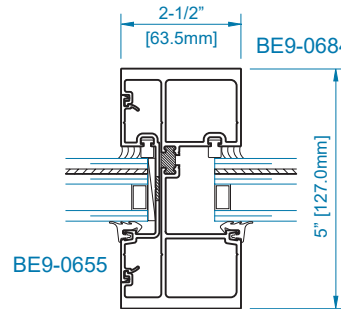

SECTION 5  
VERTICAL

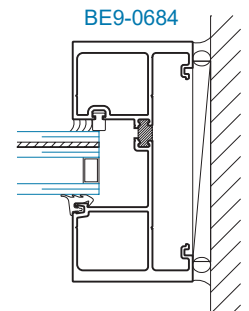

SECTION 4A opp.  
JAMB

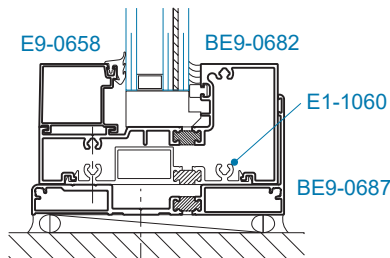

SECTION 3  
SILL

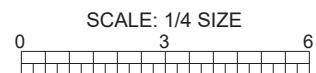

## YHS 50 TU STOREFRONT FRAMING MEMBERS SMALL MISSILE (ALL CONFIGURATIONS)

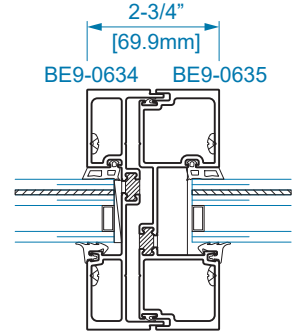
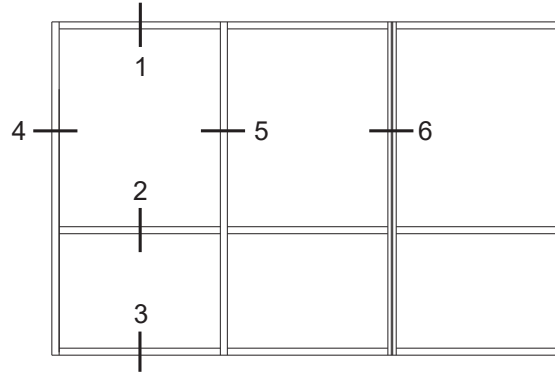

**SECTION 6  
EXPANSION  
MULLION**

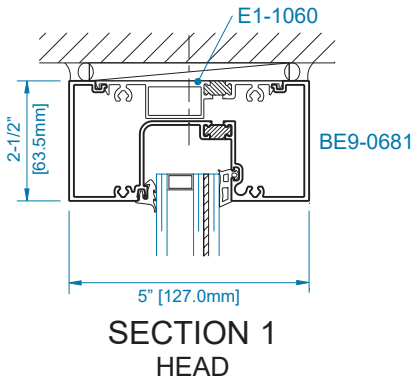

**SECTION 1  
HEAD**

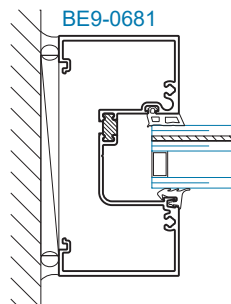

**SECTION 4  
JAMB**

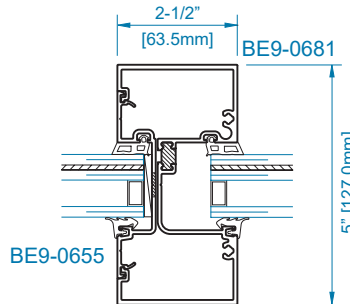

**SECTION 5  
VERTICAL**

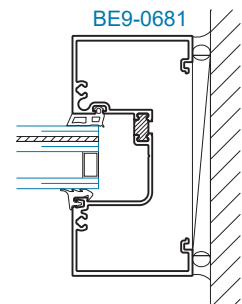

**SECTION 4 opp.  
JAMB**

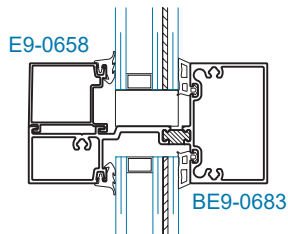

**SECTION 2  
HORIZONTAL**

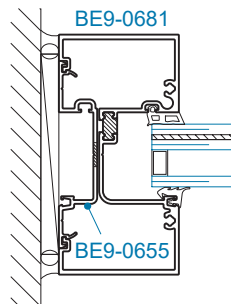

**SECTION 4A  
HEAVY JAMB**

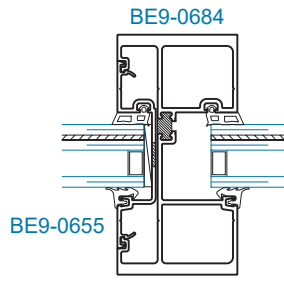

**SECTION 5A  
HEAVY DUTY  
VERTICAL**

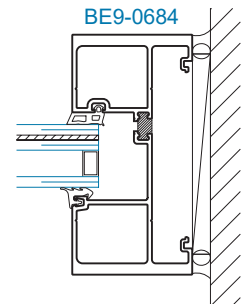

**SECTION 4B opp.  
HEAVY JAMB**

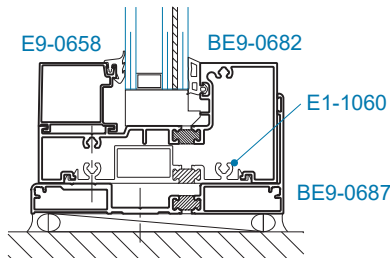

**SECTION 3  
SILL**

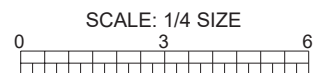

YHS 50 TU STOREFRONT FRAMING MEMBERS  
INSIDE GLAZING

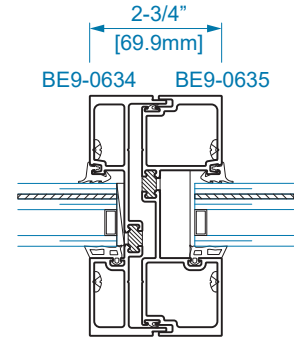
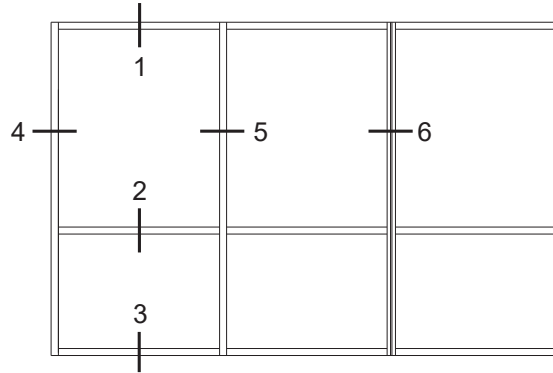

SECTION 6  
EXPANSION  
MULLION

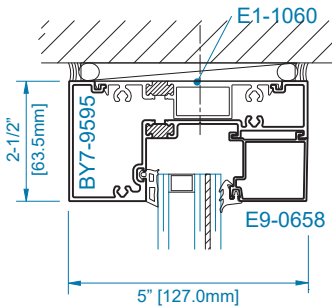

SECTION 1  
HEAD

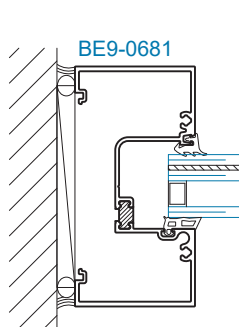

SECTION 4  
JAMB

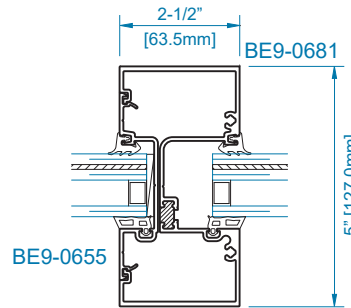

SECTION 5  
VERTICAL

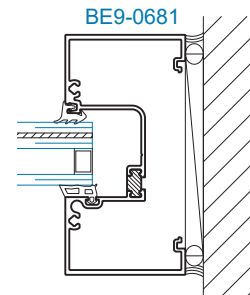

SECTION 4 opp.  
JAMB

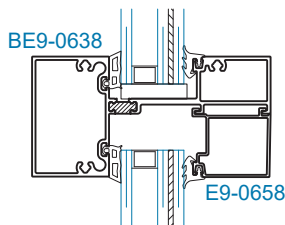

SECTION 2  
HORIZONTAL

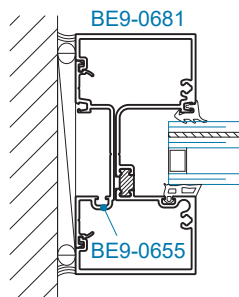

SECTION 4A  
HEAVY JAMB

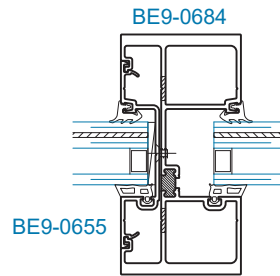

SECTION 5A  
HEAVY DUTY  
VERTICAL

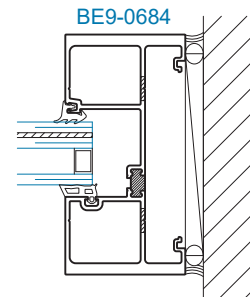

SECTION 4B opp.  
HEAVY JAMB

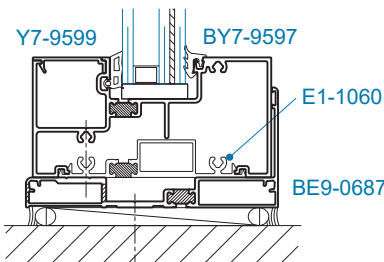

SECTION 3  
SILL

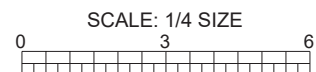

**YHS 50 TU STOREFRONT  
CORNER FRAMING MEMBERS**

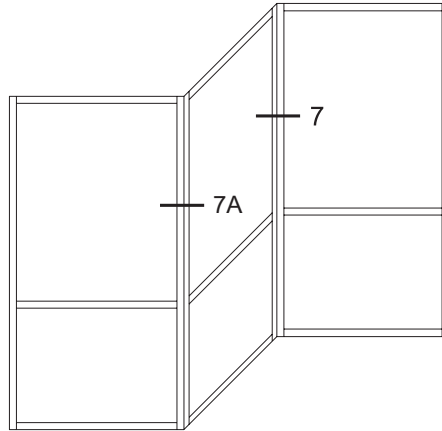

**WET GLAZING**

**DRY GLAZING**

**INSIDE GLAZING**

E9-0657

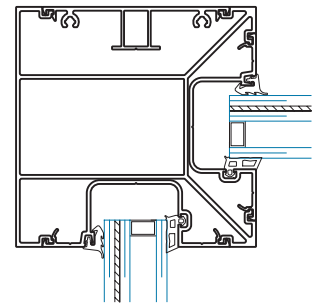
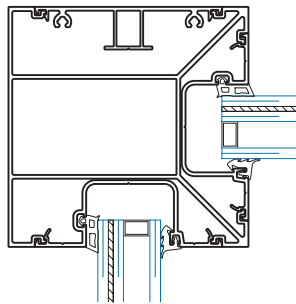
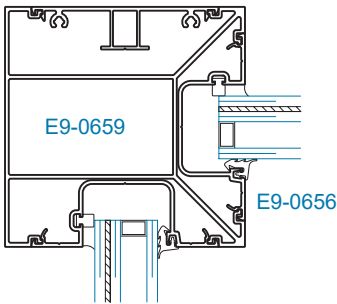

**SECTION 7**  
90° INSIDE CORNER

**SECTION 7**  
90° INSIDE CORNER

**SECTION 7**  
90° INSIDE CORNER

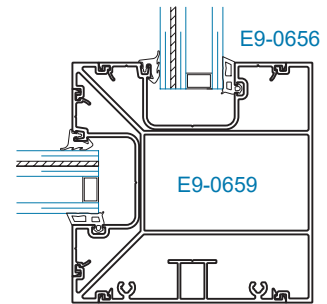
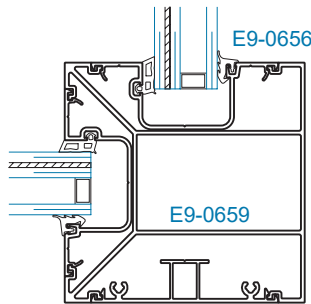
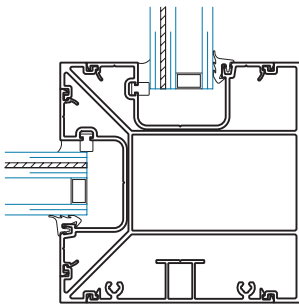

**SECTION 7A**  
90° OUTSIDE CORNER

**SECTION 7A**  
90° OUTSIDE CORNER

**SECTION 7A**  
90° OUTSIDE CORNER

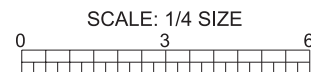

## YHS 50 TU STOREFRONT DOOR FRAMING MEMBERS (35H)

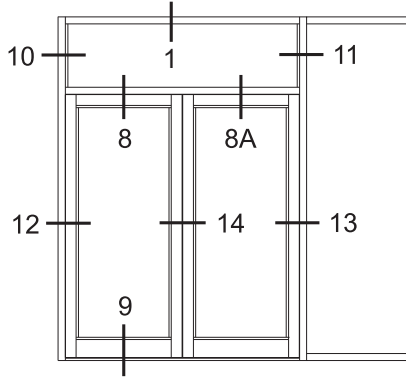
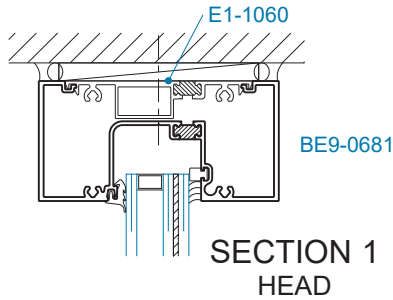

\*For 35H Threshold Details,  
See the 35H Section of this  
Manual.

**Note:** 35H Door with butt  
hinge shown.  
Refer to 35H door  
section of this manual  
for additional  
configurations.

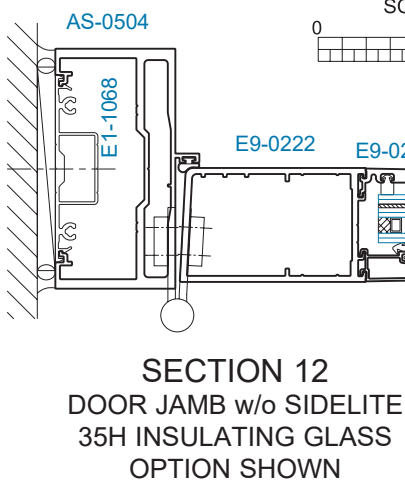
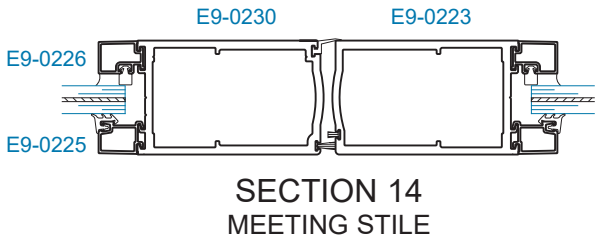
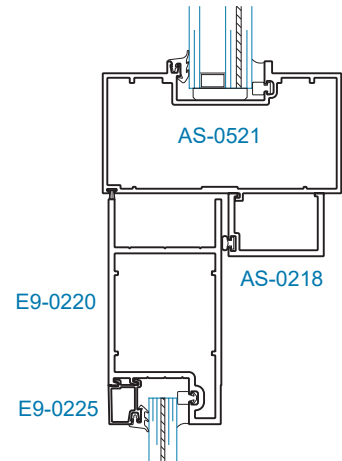
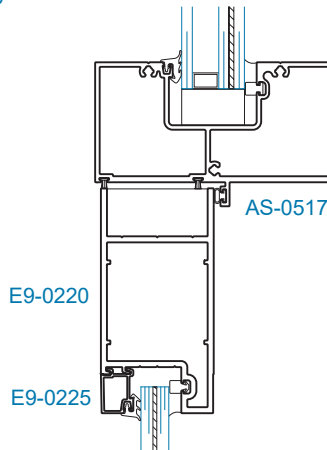
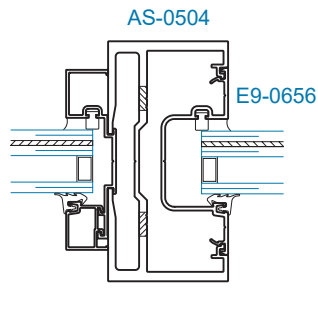
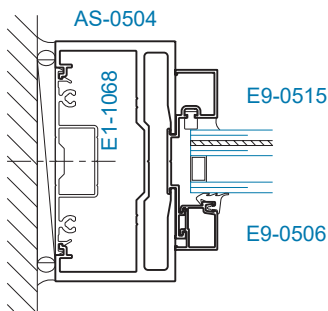

SCALE: 1/4 SIZE

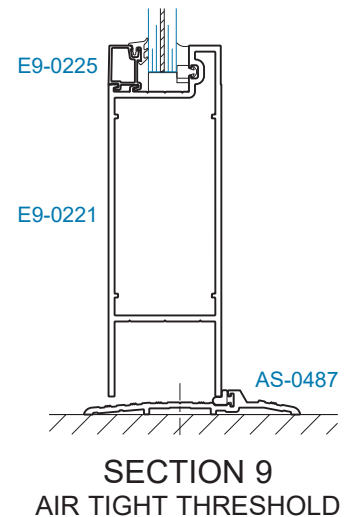
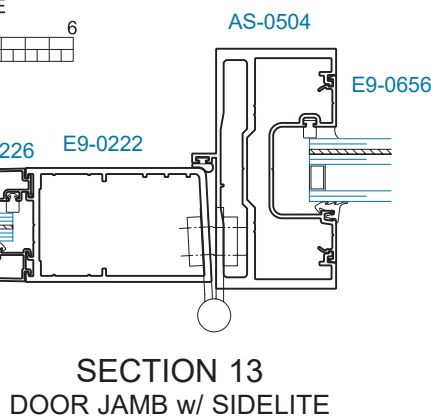
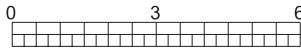

## YHS 50 TU STOREFRONT DOOR FRAMING MEMBERS (35HL)

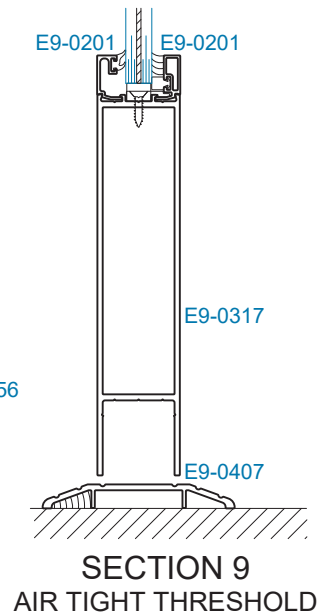
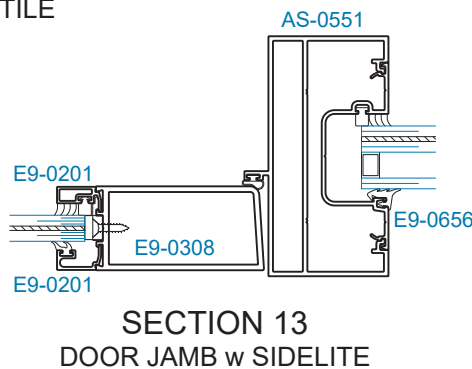
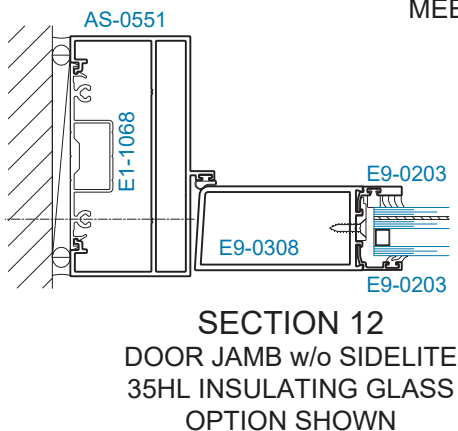
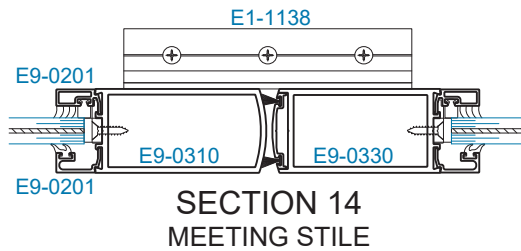
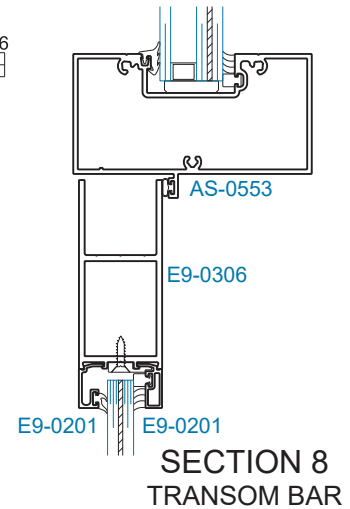
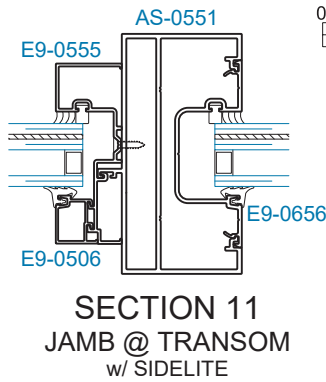
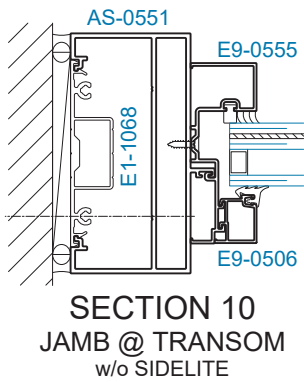
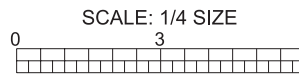
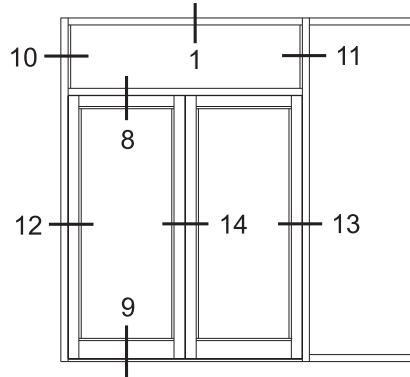
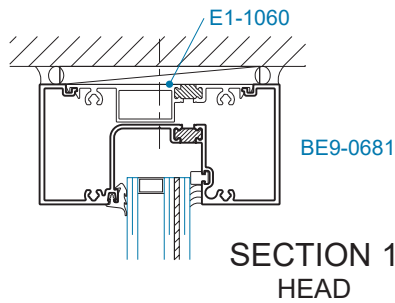

**YHS 50 TU STOREFRONT  
DOOR FRAMING MEMBERS FOR INSIDE GLAZING (35H)**

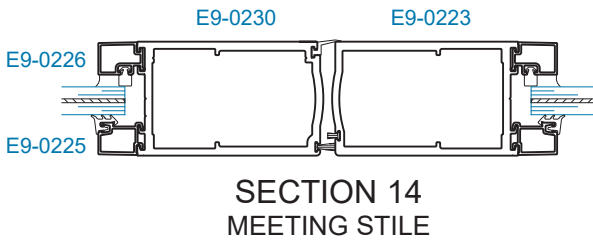
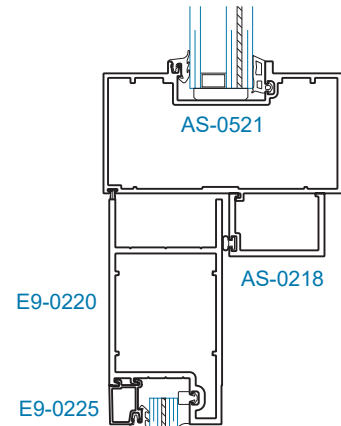
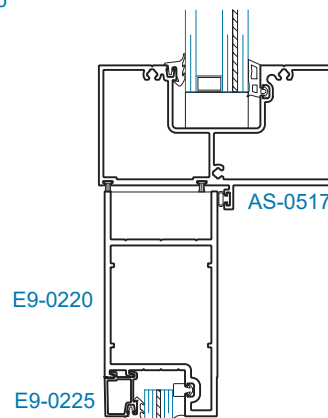
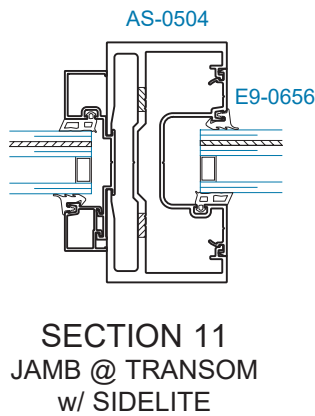
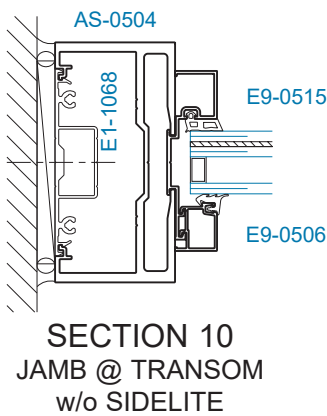
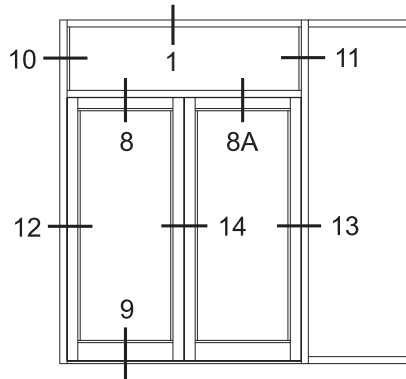
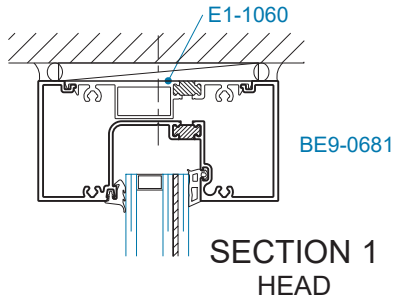

SECTION 8  
TRANSOM BAR

SECTION 8A  
TRANSOM BAR  
FOR OHCC

SECTION 14  
MEETING STILE

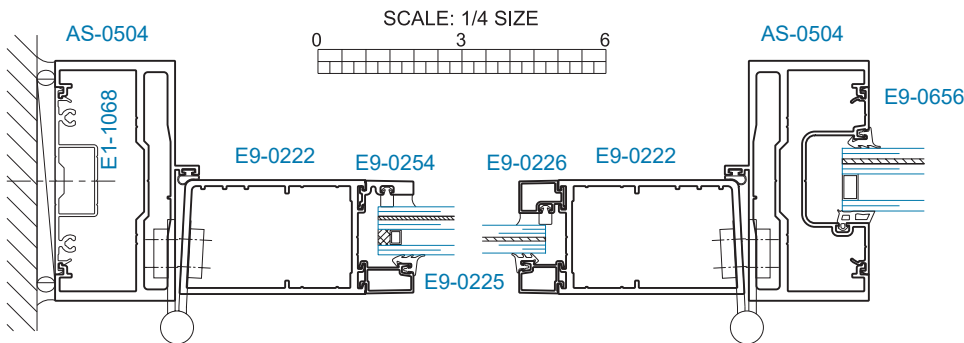

SECTION 12  
DOOR JAMB w/o SIDELITE  
35H INSULATING GLASS  
OPTION SHOWN

SECTION 13  
DOOR JAMB w/ SIDELITE

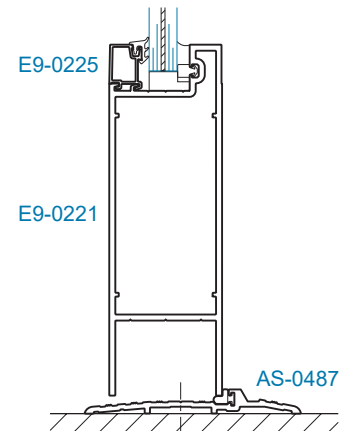

SECTION 9  
AIR TIGHT THRESHOLD

## YHS 50 TU STOREFRONT DOOR FRAMING MEMBERS FOR INSIDE GLAZING (35HL)

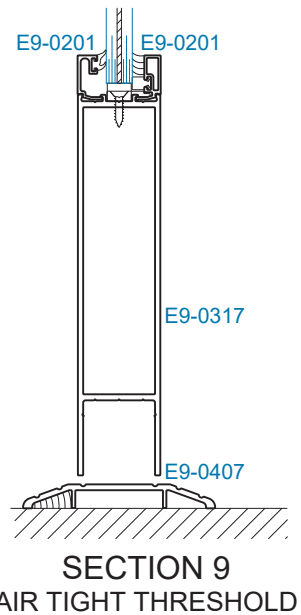
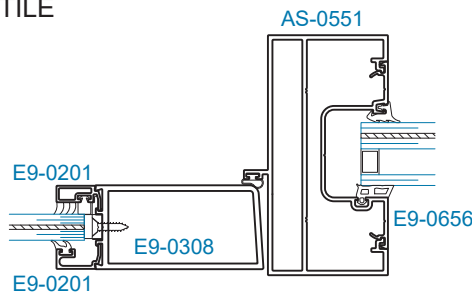
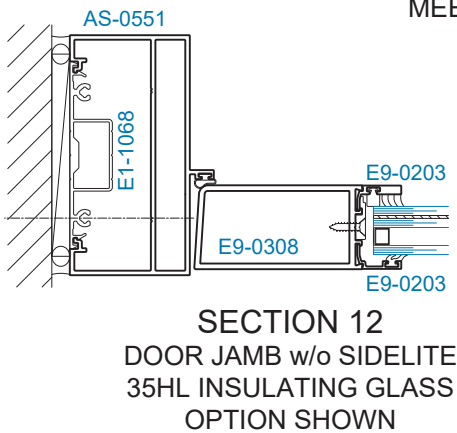
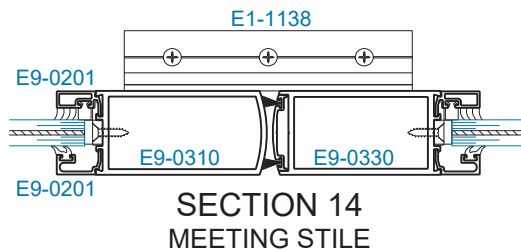
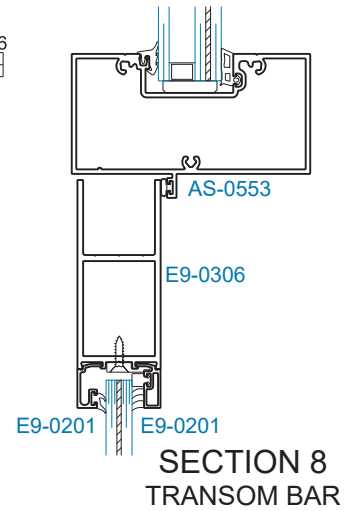
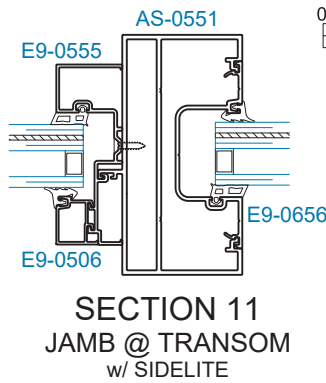
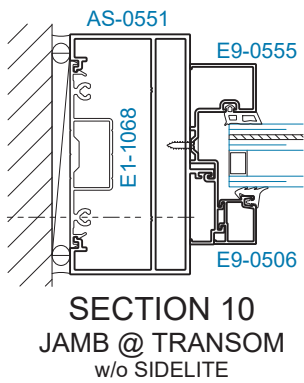
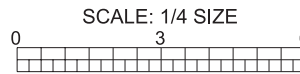
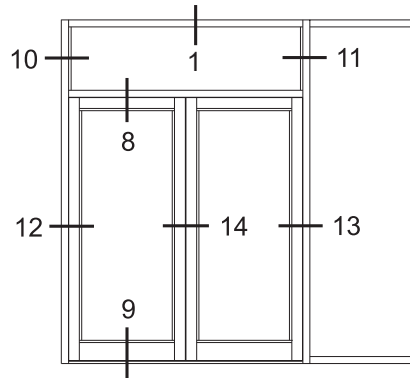
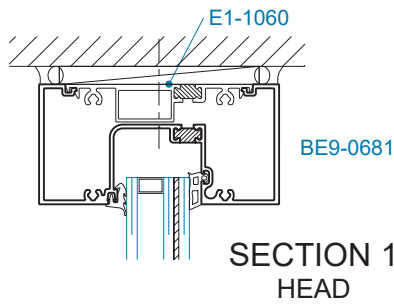

YHS 50 TU PREGLAZED STOREFRONT  
OUTSIDE, WET GLAZING

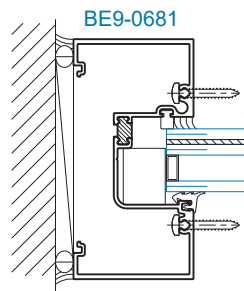
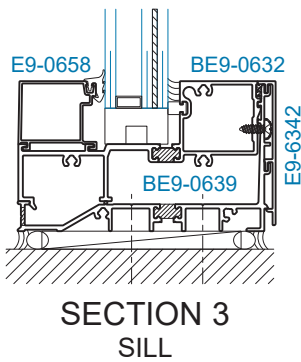
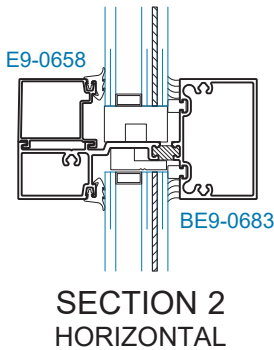
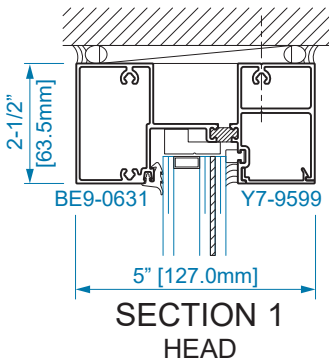
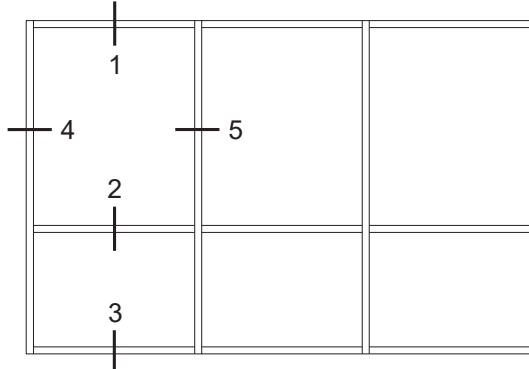

SECTION 4  
STANDARD JAMB  
±50psf

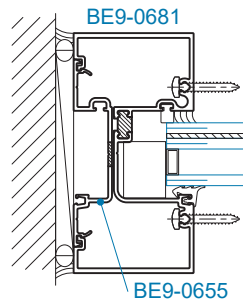

SECTION 4  
STANDARD JAMB  
±70psf

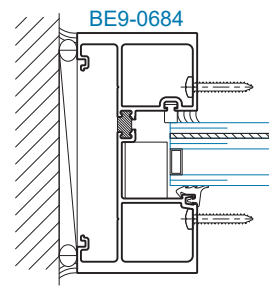

SECTION 4  
ALTERNATE JAMB  
±70psf

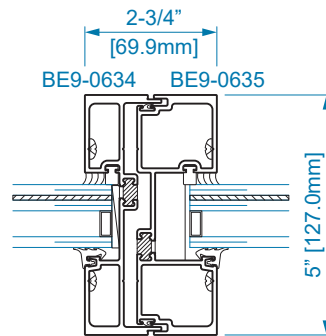

SECTION 5  
STANDARD 2-PC  
MULLION \*

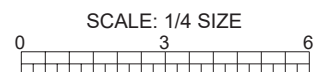

\* 2-Piece Mullion may be used as an expansion mullion in existing field glazed application.

## YHS 50 TU PREGLAZED STOREFRONT OUTSIDE, WET GLAZING

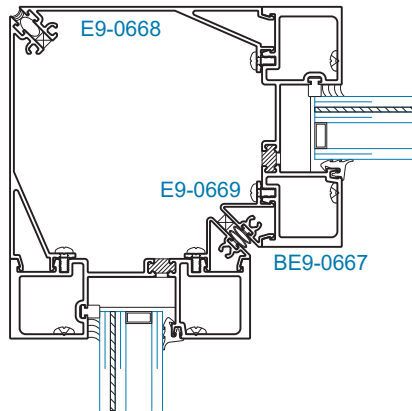
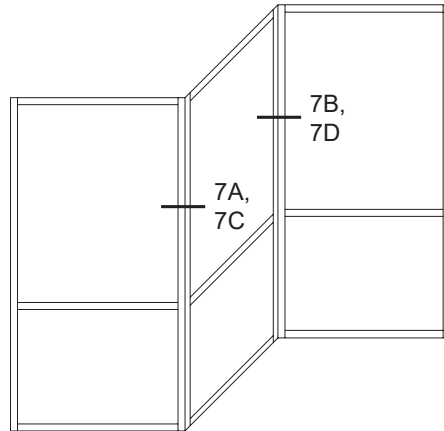

SECTION 7  
90° INSIDE CORNER

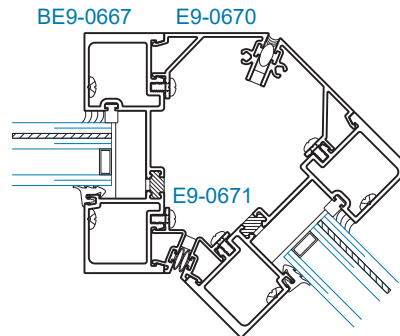

SECTION 7B  
135° INSIDE CORNER

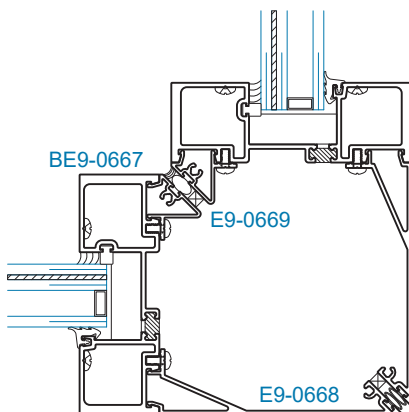

SECTION 7A  
90° OUTSIDE CORNER

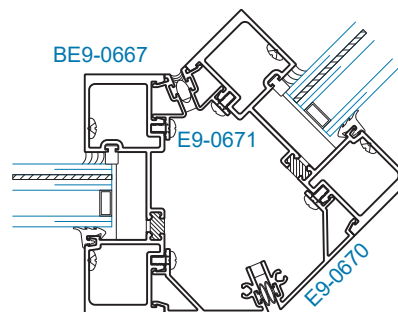

SECTION 7C  
135° OUTSIDE CORNER

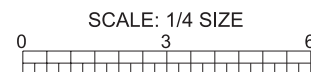

YHS 50 TU PREGLAZED STOREFRONT  
OUTSIDE, DRY GLAZING

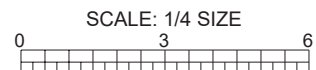
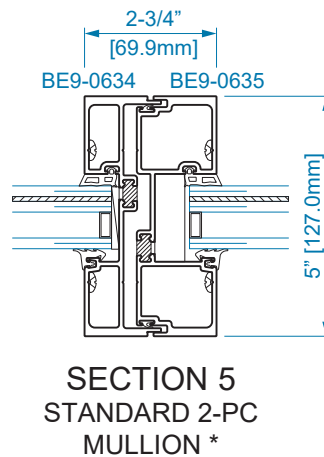
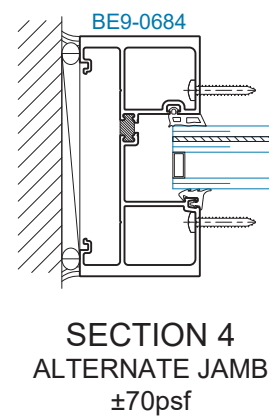
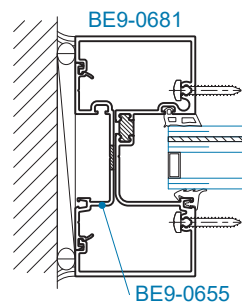
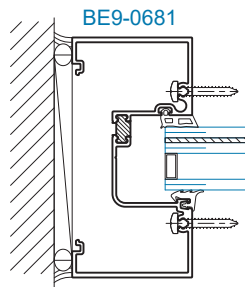
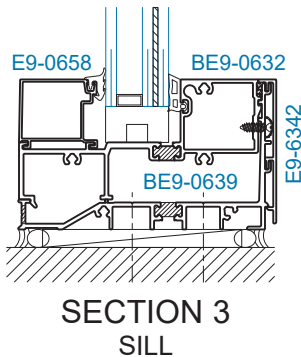
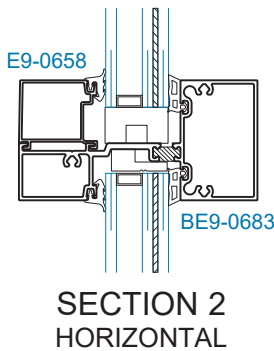
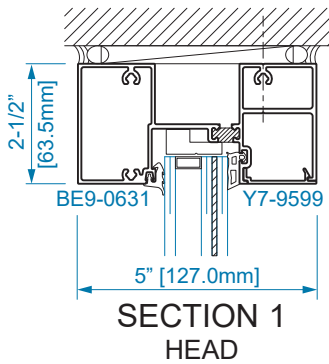
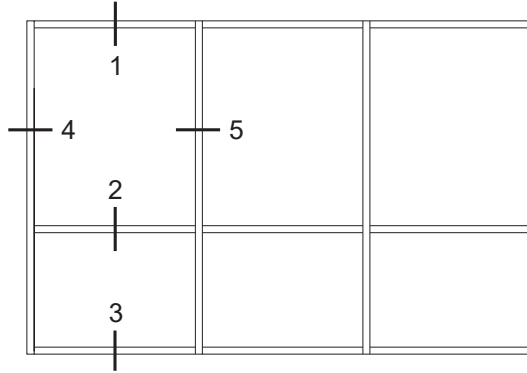

\* 2-Piece Mullion may be used as an expansion mullion in existing field glazed application.

**YHS 50 TU PREGLAZED STOREFRONT  
OUTSIDE, DRY GLAZING**

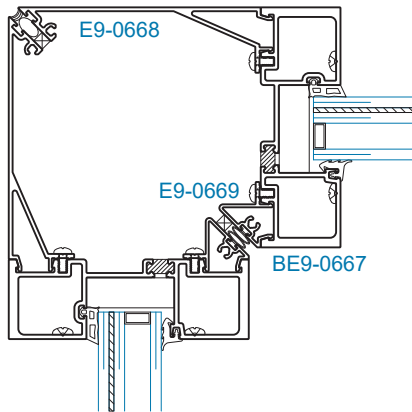
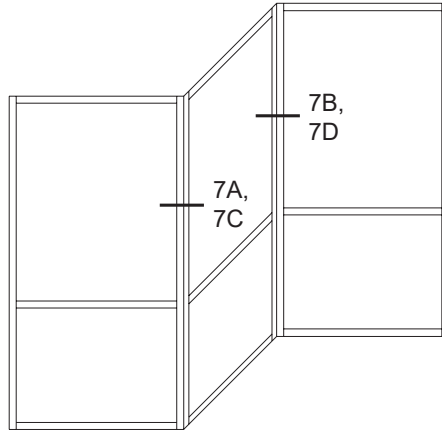

**SECTION 7**  
90° INSIDE CORNER

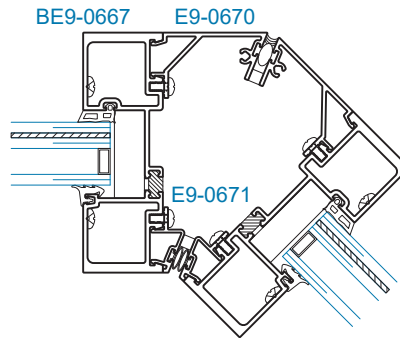

**SECTION 7B**  
135° INSIDE CORNER

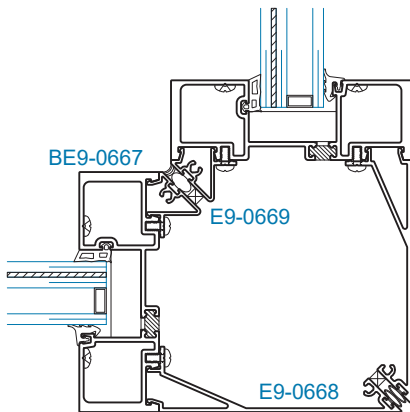

**SECTION 7A**  
90° OUTSIDE CORNER

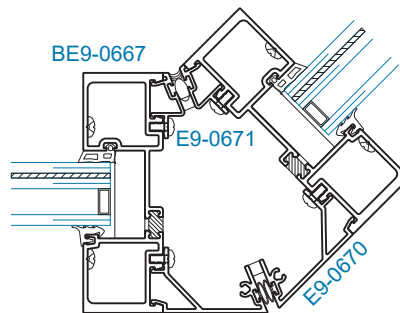

**SECTION 7C**  
135° OUTSIDE CORNER

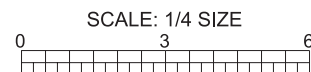

YHS 50 TU PREGLAZED STOREFRONT  
INSIDE, DRY GLAZING

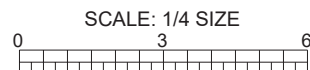
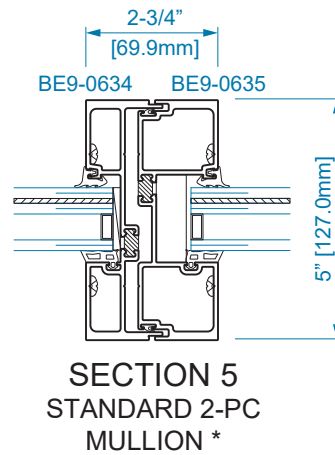
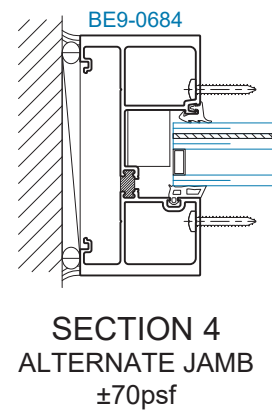
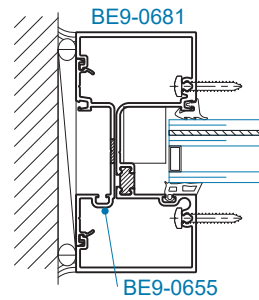
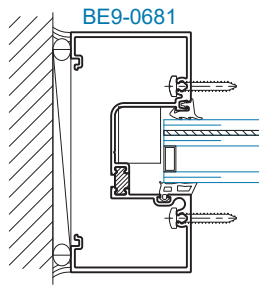
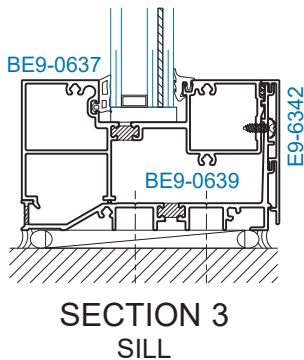
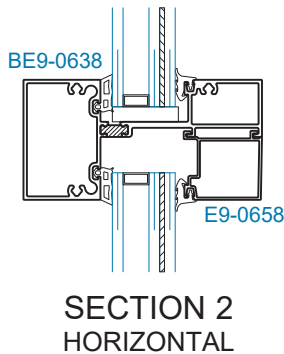
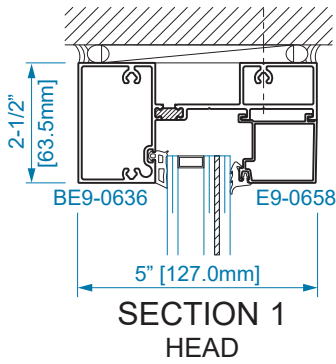
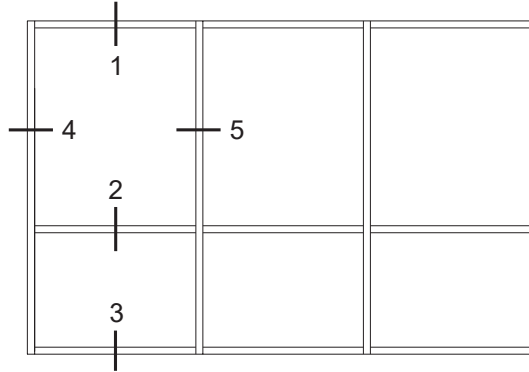

\* 2-Piece Mullion may be used as an expansion mullion in existing field glazed application.

**YHS 50 TU PREGLAZED STOREFRONT  
INSIDE, DRY GLAZING**

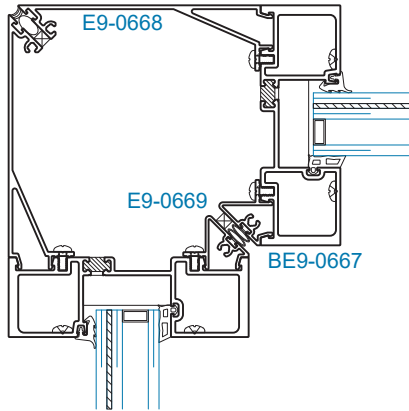
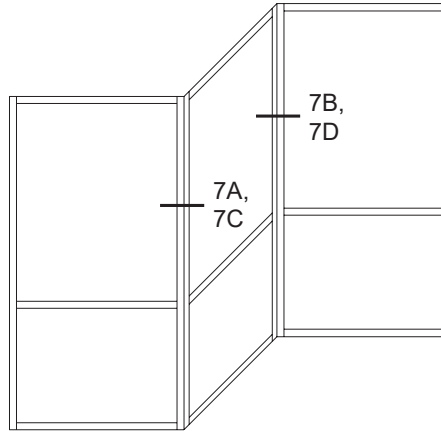

**SECTION 7**  
90° INSIDE CORNER

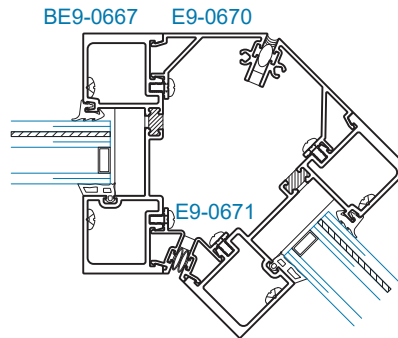

**SECTION 7B**  
135° INSIDE CORNER

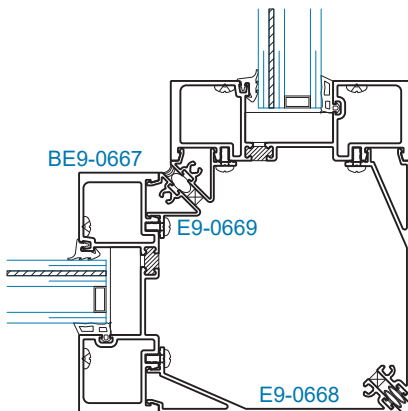

**SECTION 7A**  
90° OUTSIDE CORNER

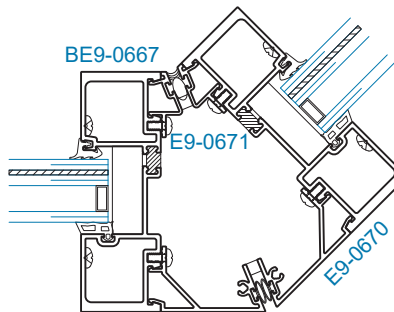

**SECTION 7C**  
135° OUTSIDE CORNER

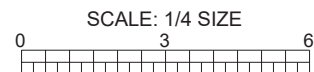

## YHS 50 TU STOREFRONT WIND LOAD CHARTS

### NON-FLORIDA APPLICATIONS

DEFLECTION CRITERIA: AAMA TIR-A11 - L/175 or

L/240 + 1/4" (6.4mm) - FOR SPANS GREATER THAN 13'-6" (4.1m) BUT LESS THAN 40'-0" (12.2m)

CODES AND SPECIFICATIONS MAY VARY, NO SINGLE LITE OF GLASS SHALL DEFLECT MORE THAN 3/4" (19.1mm)

ALLOWABLE WIND LOAD STRESS

YKK AP tested standard. Contact YKK AP for more information.

These charts include unbraced length analysis and are based off at least one horizontal being placed at the midpoint of the span. For other applications, please contact YKK AP engineers at 1-866-955-2732.

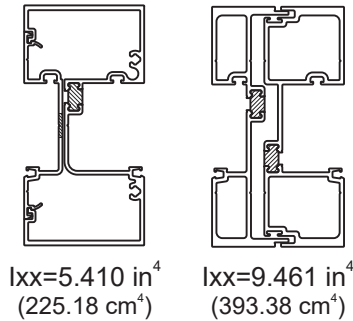
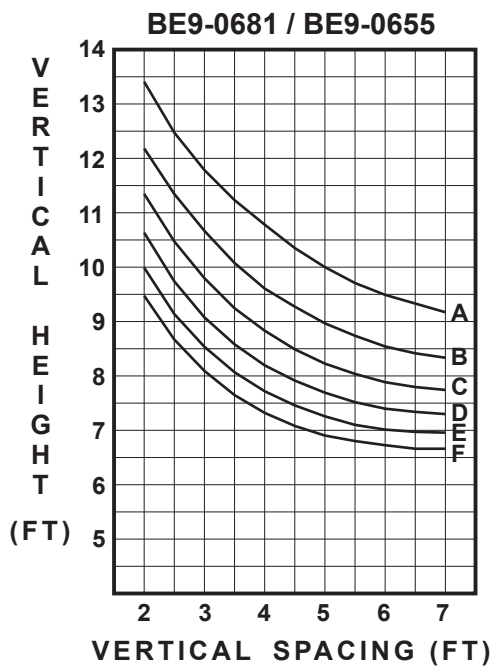

- A = 30 PSF (1440 Pa)
- B = 40 PSF (1920 Pa)
- C = 50 PSF (2390 Pa)
- D = 60 PSF (2870 Pa)
- E = 70 PSF (3350 Pa)
- F = 80 PSF (3830 Pa)

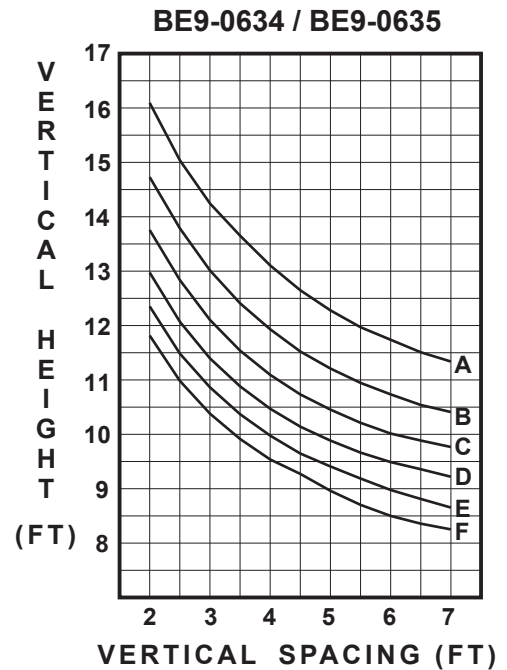

## YHS 50 TU STOREFRONT WIND LOAD CHARTS

### NON-FLORIDA

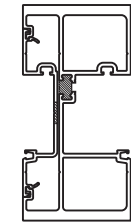
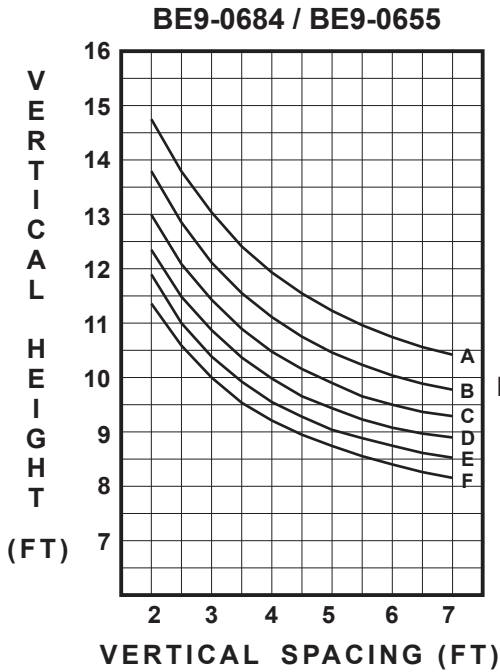

$I_{xx}=9.495 \text{ in}^4$   
(395.21  $\text{cm}^4$ )

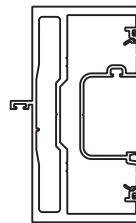

$I_{xx}=9.791 \text{ in}^4$   
(407.53  $\text{cm}^4$ )

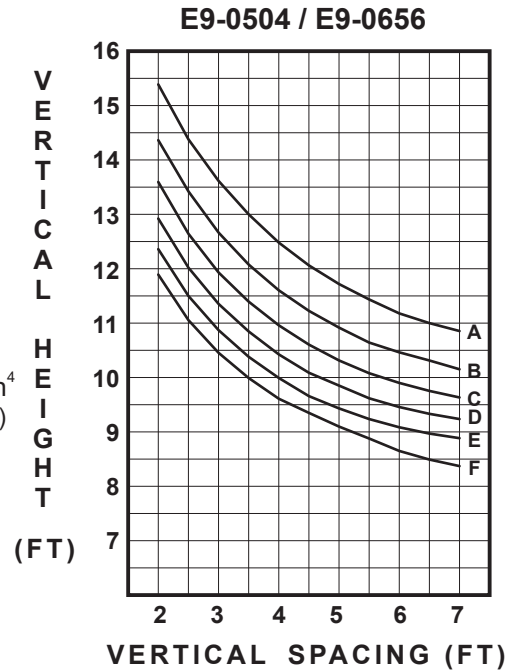

- A = 40 PSF (1920 Pa)
- B = 50 PSF (2390 Pa)
- C = 60 PSF (2870 Pa)
- D = 70 PSF (3350 Pa)
- E = 80 PSF (3830 Pa)
- F = 90 PSF (4310 Pa)

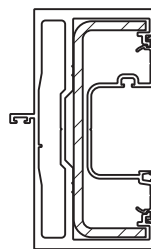
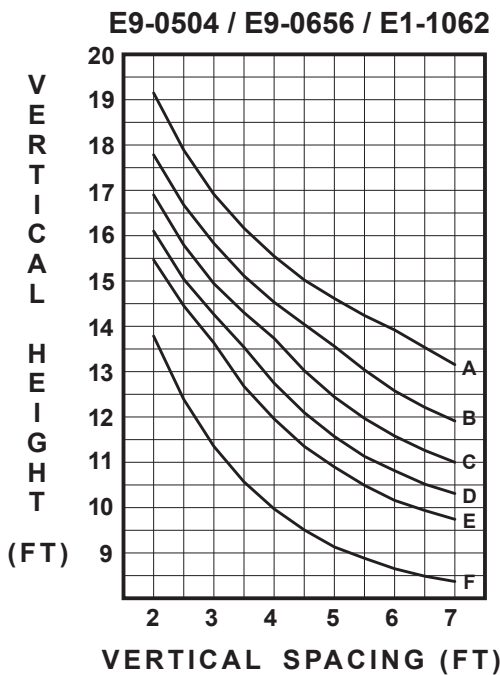

$I_{xx}=19.918 \text{ in}^4$   
(829.05  $\text{cm}^4$ )